

Town of Brookfield
645 N. Janacek Road
Brookfield, WI 53045
(P) 262-796-3788
(F) 262-796-0339



MEETING NOTICE

Meeting will be held at the
Town of Brookfield Municipal Building, Eric Gnant Room
645 N. Janacek Road, Brookfield, WI

Wednesday, March 12, 2025

Architectural Review Committee

6:00 p.m

AGENDA

- 1) Call to Order.
- 2) Meeting Notices.
- 3) Approval of Agenda.
- 4) Approval of Minutes.
 - a. February 20, 2025 Meeting Minutes
- 5) Old Business:
 - a. Rob Kahler Jr., representing Callister's Christmas and Master Z's, requesting approval for an amended request for wall sign face change on freestanding sign, located at 19255 W Bluemound Rd.
- 6) New Business:
 - a. Lori Dominiak (FASTSIGNS of Waukesha), representing HF Massage, requesting approval for a wall sign, located at 19555 West Bluemound Road, Suite 6.
 - b. Lisa Burck (Innovative Signs) representing Innovative Signs, requesting review and approval for a permanent freestanding monument sign, located at 21700 Doral Road.
 - c. Ken Krahe (MSI General, Inc), representing Silgan Containers, requesting review and approval for two wall signs, one monument sign reface, and additional internal signage, located at 21027 Crossroads Circle.
 - d. Ken Krahe (MSI General, Inc), representing Silgan Containers, requesting review and approval for exterior lighting plan amendment to install LED lights in the parking lot, located at 21027 Crossroads Circle.
 - e. Dave Salkin (Signs and Lines by Stretch), representing Kerns Carpet, requesting approval of pylon sign face change and awning sign, located at 19655 West Bluemound Road.
 - f. Patty Kerns (Kerns Carpet), representing Kerns Carpet, requesting approval of replacing an awning and exterior painting, located at 19655 West Bluemound Road.
- 7) Communication and Announcements.
- 8) Adjourn.

Posted this 6th day of March, 2025
Bryce Hembrook
Town Planner

TOWN OF BROOKFIELD
ARCHITECTURAL REVIEW COMMITTEE MINUTES
FEBRUARY 20, 2025

The regular meeting of the Architectural Review Committee was held in the East Conference Room of the Town Hall, 645 N Janacek Road, Brookfield, WI.

1) CALL TO ORDER

Chairman Dean Pearson called the meeting to order at 6:00 p.m. with the following people present: Town Planner Bryce Hembrook; Town Supervisors John Charlier and Steve Kohlmann; and Committee members, Richard Diercksmeier, Alan Lee, and Matt Paris.

2) MEETING NOTICES

Planner Hembrook reported that the meeting was noticed in accordance with Open Meeting Law.

3) APPROVAL OF AGENDA

Motion by Charlier to approve the agenda as presented.

Seconded by Kohlmann.

Motion carried unanimously.

4) APPROVAL OF MINUTES

Motion by Kohlmann to approve the minutes of the January 8, 2025 minutes as presented.

Seconded by Diercksmeier.

Motion carried unanimously.

5) OLD BUSINESS

a. None.

6) NEW BUSINESS

a. Lisa Burck (Innovative Signs), representing Proactive MD Family Health Center, requesting review and approval for installation of wall signage and multi-tenant freestanding signage, located at 21600 Watertown Road.

Hembrook presented the item and provided details from the staff report. The Committee did not have any concerns.

Motion by Paris to approve installation of wall signage and multi-tenant freestanding signage for Proactive MD Family Health Center, located at 21600 Watertown Road as presented.

Seconded by Kohlmann.

Further discussion: None.

Motion carried unanimously.

b. Nancy Jensen, representing 4Ever Young, requesting review and approval of permanent wall signage and window signage, located at 20400 West Bluemound Road, Suite 400.

Hembrook presented the item and provided details from the staff report. The Committee discussed the proposed size and mentioned that it appeared to be proportional and meets the master sign plan recommendation.

Motion by Paris to approve permanent wall signage and window signage as presented for 4Ever Young, located at 20400 West Bluemound Road, Suite 400.

Seconded by Charlier.

Further discussion: None.

Motion carried unanimously.

7) COMMUNICATION AND ANNOUNCEMENTS

None.

8) ADJOURN

Motion by Charlier to adjourn at 6:13 pm.

Seconded by Diercksmeier.

Motion carried unanimously.

Respectfully submitted,
Bryce Hembrook, Town Planner

BH/lr



Building a Better World
for All of Us®

TOWN OF BROOKFIELD ARCHITECTURAL REVIEW COMMITTEE STAFF REPORT

TO: Architectural Review Committee

FROM: Bryce Hembrook, AICP
Town Planner

REPORT DATE: March 6, 2025
ACC MEETING DATE: March 12, 2025

RE: ARC Staff Report – March 2025 Agenda Item

Callister's/Master Z's – Sign Review

Applicant: Rob Kahler Jr., Callister's Christmas by Master Z's

Location: 19233 W Bluemound Rd

Request: Approval for installation of a wall mounted sign and sign face change on existing freestanding sign

- The applicant and town staff had a meeting to discuss options for the signage and occupancy.
- The applicant is proposing to have dual occupancy for Master Z's and Callister's Christmas year-round. Around the holiday season, the space will be occupied predominantly by Callister's Christmas and Master Z products will be available for sale. During the remaining months, the Master Z's area will expand and Callister's Christmas items will be on sale as well.
- The applicant submitted a plan of operation narrative that was approved by the Plan Commission in January.
- The applicant is proposing to keep the red Master Z's sign as is, add the Blue Callister's sign on the pylon sign as proposed at last month's meeting, and remove the wall sign above the entrance (which was approved at the November Plan Commission).

HF Massage – Sign Review

Applicant: Lori Dominiak (FASTSIGNS of Waukesha) – Representing HF Massage

Location: 19555 W Bluemound Rd Ste 6

Request: Approval for installation of wall signage

- Applicant is requesting approval for a wall sign.
- Proposed sign
 - 28.3 square foot sign near the entrance
 - Green letters with black trim.
 - Internally illuminated and night elevations are included in the packet.
 - The application mentions that the tenant space is approx. 29', which would allow for 23.2 square feet.
 - This would require an exception granted by the ARC.
- Proposed signage appears to meet code requirements, except for the sign area.

Engineers | Architects | Planners | Scientists

Short Elliott Hendrickson Inc., 501 Maple Avenue, Delafield, WI 53018-9351
SEH is 100% employee-owned | sehinc.com | 262.646.6855 | 888.908.8166 fax

Innovative Signs – Sign Review

Applicant: Lisa Burck (Innovative Signs) – Representing Innovative Signs

Location: 21700 Doral Road

Request: Approval of Freestanding Sign

- Innovative Signs is proposing to install a freestanding monument sign on their property.
- Proposed Sign
 - Approximately 60 square feet, including the support structure.
 - Height = 6’5”.
 - Setback = Specific setback not provided. There is a 5’ setback requirement for freestanding signs.
 - Looking at the aerial photo for the property, it appears that there is a landscaping bed approximately 5’ from the property line and meeting this setback may not be attainable unless a portion of the landscaping is removed for the signage.
 - The ARC may consider allowing a setback exception to allow the sign closer to the property line, especially since there is limited space to place a sign due to the parking and driveway layout.
 - The sign includes address numerals near the top of the sign.
 - I estimated that the numeral font height is 6” and 8” is the typical requirement.
 - The applicant should confirm the proposed size and potentially increase the height.
 - Applicant has provided night renderings of the proposed sign
 - Proposed colors = blue, yellow, and white

Silgan Containers - Signage

Applicant: Ken Krahe (MSI General, Inc) – Representing Silgan Containers

Location: 21027 Crossroads Circle

Request: Approval of Two Wall Signs, One Monument Sign Re-Face, and Other On-Site Signage

- Silgan Containers recently purchased the property and a small addition for a boiler room addition and warehouse/mechanical room was approved in 2024.
- The applicant is now proposing to add signage on the building.
- Proposed Signage:
 - Monument Sign A
 - Proposing to reface the existing monument sign (formerly Kalmbach Publishing) with company logo.
 - Sign area is approximately 23.6 square feet.
 - Gray background and white lettering.
 - Letters will be internal illuminated.
 - Address numerals are included but are proposed to be 3” instead of the required 8”.
 - Sign location will remain the same.
 - Except for the address numeral height, this sign meets code requirements. The ARC may grant an exception for this.
 - Wall Sign B
 - Proposing a 53.21 square foot wall sign on the front elevation.
 - This sign is currently on their existing location in Oconomowoc and will be removed and installed on the new building.
 - The sign has a gray background with a blue logo and dark gray lettering.

- Sign will be internally illuminated and the packet includes a nighttime rendering.
- Building Frontage along right-of-way = approximately 450'
 - Proposed sign area meets requirement.
- Wall Sign C
 - Facing parking lot to the east.
 - Sign area is approximately 11.87 square feet.
 - Internally illuminated sign.
 - Blue and gray logo.
 - Building frontage on the east side of the building is approximately 65 square feet (52 square feet permitted if using typical building frontage calculation).
 - Does not directly face the right-of-way but is facing the parking lot.
 - The ARC may grant an exception to the requirement to allow this sign.
- Additional Signage
 - The signage package submittal includes additional signage that does not require a permit but does require ARC approval.
 - The signs provide directions and other information for employees, visitors, and trucks.
 - The signs are proposed to repurpose the existing post and panel signs with the company’s logo and information.
 - The code mentions that these signs should be directional in character, without graphics or tag lines, and be architecturally consistent with the building design concept and other signage on the property.
 - The proposed signs include logos but the ARC can approve as presented as an exception.
 - The signs that they are replacing included the company logo.

Silgan Containers – Exterior Lighting

Applicant: Ken Krahe (MSI General, Inc) – Representing Silgan Containers

Location: 21027 Crossroads Circle

Request: Approval of Exterior Lighting Plan Amendment to Install LED Lights in the Parking Lot.

- Applicant is proposing to replace existing light fixtures with new LED lights.
- A photometric plan and lighting specs are provided in the packet.
- The Town Engineer reviewed the proposed lighting plan and had the following comments:
 - The photometric plan should be updated to include the light level at the property line. No point on the property line shall exceed .2 footcandles.
 - NOTE: An updated photometric plan was provided and is included in the electronic version of the packet. An update may be provided at the time of the meeting.
 - The proposed fixtures appear to be full cutoff, meeting Town ordinance.
 - The parking lot lighting meets the Town ordinance (minimum .4fc required), but just as an observation, the average light level (5.05fc -) seems high. Typical parking lot light levels range from .5fc to 3fc.

Kerns Carpet - Signage

Applicant: Dave Salkin (Signs and Lines by Stretch) - Representing Kerns Carpet

Location: 19655 West Bluemound Road

Request: Approval of Pylon Sign Face Change and Awning Sign

- Applicant is requesting approval for a sign face change for an existing pylon sign and to approve an awning sign.

- Pylon Sign
 - Size = Approximately 97.92 square feet.
 - Exceeds typical requirement but this sign is existing.
 - Pylon signs are generally not permitted; however, this sign is a legal, nonconforming sign and face changes are acceptable as long as the sign structure is not modified.
 - Sign will be internally illuminated and a nighttime rendering is provided in the packet.
 - Dark blue background and white lettering.
 - Double-sided sign.
- Awning Sign
 - The applicant is requesting to replace their awning with a new navy blue awning that is proposed to include a Kerns logo.
 - The code does not discuss awning signs in great detail but staff believes that this type of sign would be categorized as a wall supported sign.
 - The proposed sign area is approximately 55 square feet.
 - Tenant frontage space is approximately 65, thus the typical square feet allowance is 52 square feet.
 - Proposed sign exceeds by 3 square feet. An exception may be granted.
 - The awning that they are replacing currently has multiple sign display areas on the awning.
 - The awning is proposed to be Navy Blue and the sign portion is white lettering.

Kerns Carpet – Exterior Alterations

Applicant: Patty Kerns - Representing Kerns Carpet

Location: 19655 West Bluemound Road

Request: Approval of Replacing Awning and Exterior Painting

- Applicant is replace their existing awning with a new fabric awning above walkway.
- Applicant is proposing to paint the overhang and soffit to match the awning.
- Also proposing to paint the metal siding and trim a color similar to the existing taupe-beige.
- 3 down lighting fixtures are proposed as well. The applicant should provide more information regarding this at the meeting.

Master Zs is proposing that the previously approved Callisters Christmas sign be placed directly underneath the large Master Zs sign, on the monument location. We will then remove the signage above the mezzanine all together.

(See submitted photo)

Master Zs / Callisters Christmas, at 19233 W Bluemound Road, will be selling Callisters Christmas products heavily for 3 to 4 months of the year. The remaining months in the year you will be able to purchase Christmas products, but you will also be able to purchase other products from our Master Zs lineup of offerings. This can include patio furniture, hot tubs, pool tables, recreational games, umbrellas, arcade games, and any other products Master Zs currently offers. Christmas will shrink down in the spring and summer to make room for other products and become large when in season. After the Christmas season, I currently prefer to start this spring with overstock and clearance/discontinued items from our complete line up of product offerings.

This location is 17,000 sq ft. At any given time, there will be 5000 to 10,000 sq ft of Master Zs line-up of non-Christmas related items, while the rest of the 5000 to 10,000 sq ft will be Christmas related products. Again, during the Christmas season the showroom will be mostly occupied with all of our Christmas related items. The flexibility of this space allows us to expand and shrink when needing to retail more or less of a specific category, at any given season of the year.

The goal of this location is to be open at the same hours as our current regular hours we offer customers.

Monday through Friday 10am –7pm

Sat by appointment – or 10am- 6pm depending on staffing availability

During the Christmas season the hours may differ to include Saturdays and later evenings during the week.

* 19233 W. BLWEMOUND ROAD

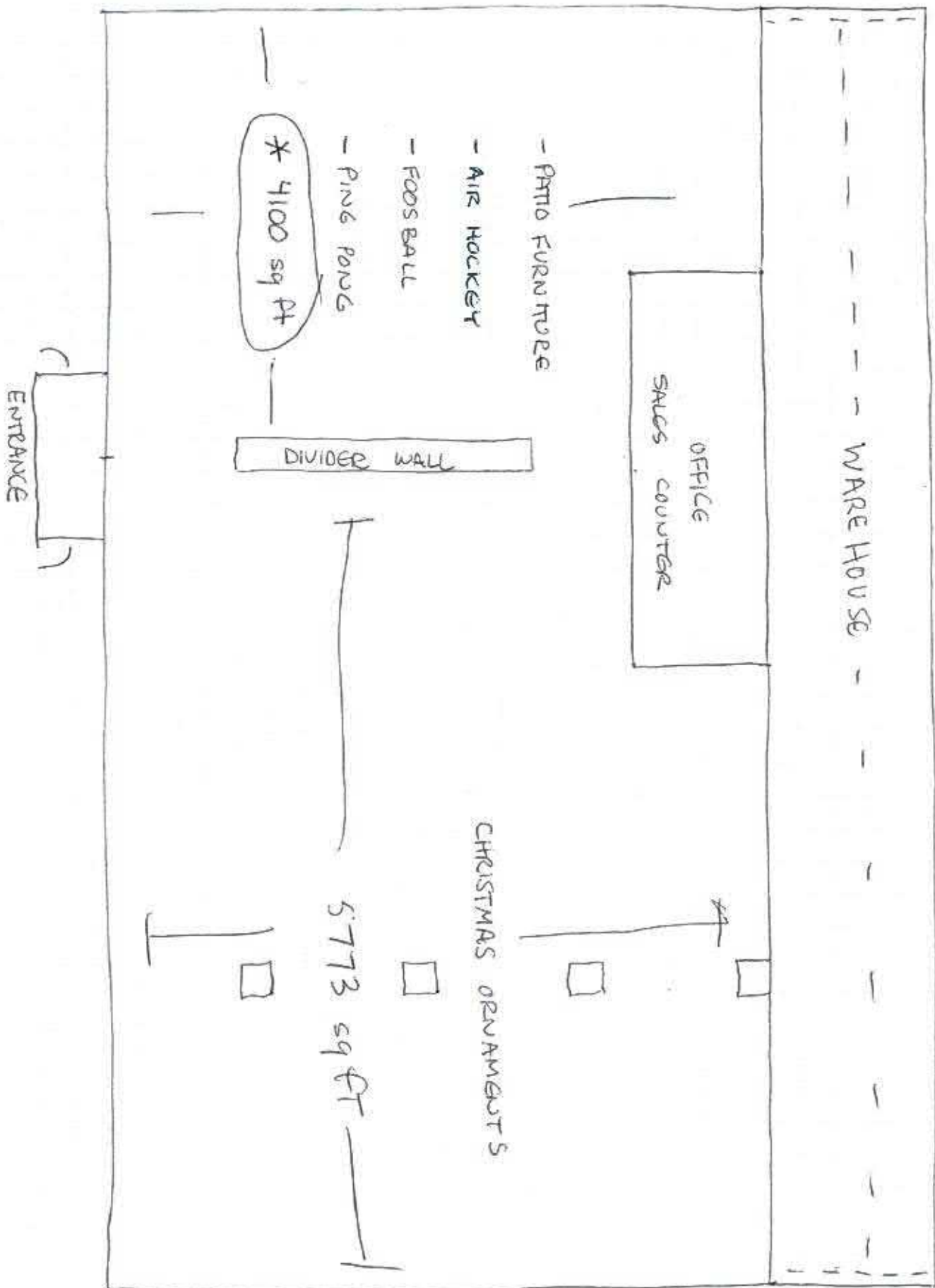

* THE FURNITURE AND GAMES MAY SHIP ONCE OCTOBER THEN DECEMBER ARRIVES, OR IT MAY STAY THE SAME, IT DEPENDS ON WHAT THERE IS A GREATER NEED FOR

This sign above the OPEN SIGN WILL
BE REMOVED - INCLUDING THE FRAME AROUND
IT.

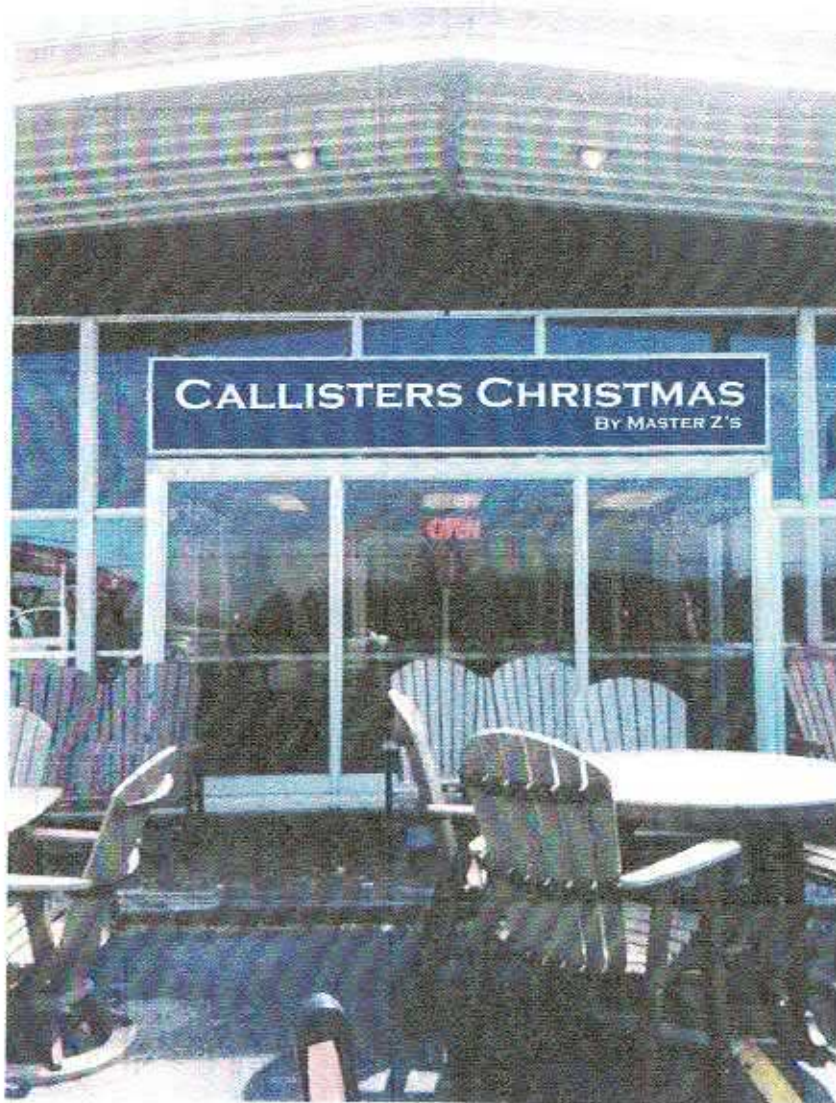

MASTER
Z's

Casual Living
Furniture
& Design

← FACE CHANGE
TO CALLISTERS

Red Master Z's
sign is proposed
to remain

CALLISTERS
CHRISTMAS



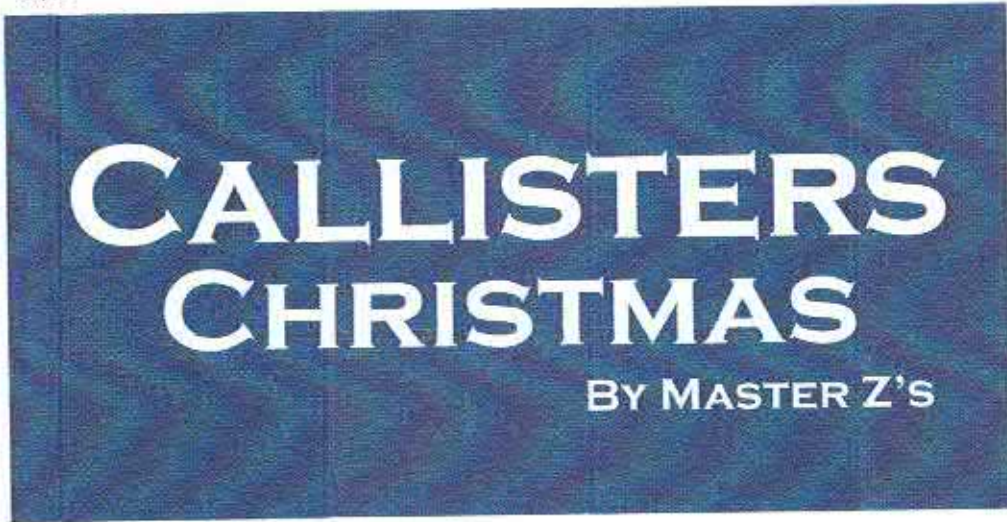

59.125"

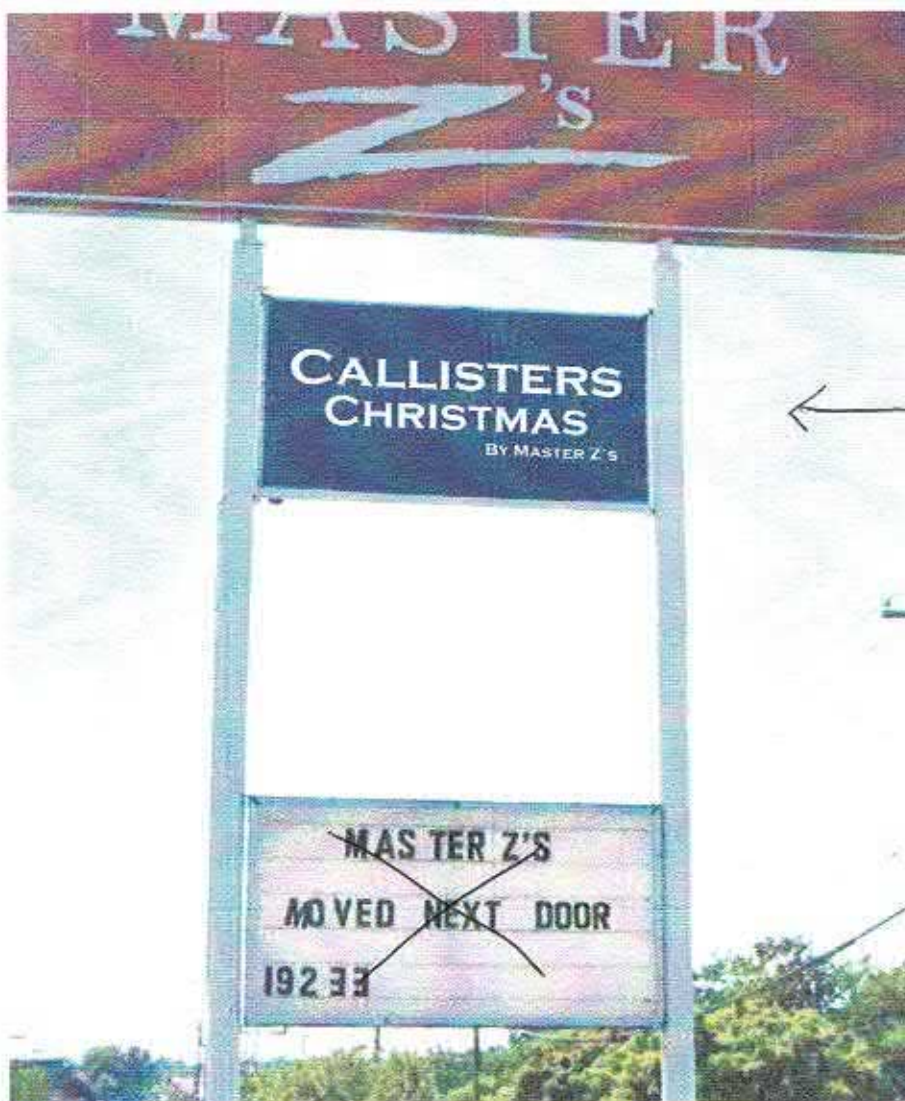

←

← PROPOSED SIGN
FACE CHANGE
- BOTH SIDES

HF Massage

*The Honeybee
Salon*

NO
PARKING
12-1-17

8

6





136" W

HF Massage

15.5" H

30" H

8

The Honeybee
Salon

6

NO
PARKING
FIRE
LANE



136"W

HF Massage

15.5"H

30"H





(1) 4" - 4.5" - O.D
Wall: Sch. 40

Customer

Innovative Signs

Date	Project Manager
02/17/2025	Ben P.
Order #	Designer
EST - 14784	Brian H.
Sq. Ft.	Surveyor
66	Ben P.
Sides	Mounting
S/S <input checked="" type="checkbox"/> D/S <input type="checkbox"/>	Saddle Mounting
Pole Shape	Pole Size
<input type="checkbox"/> Square	(1) 4" - 4.5" - O.D
<input checked="" type="checkbox"/> Circle	Wall: Sch. 40

Materials & Specifics

Monument Sign

- 1/4" routed aluminum face
- .080 Aluminum shroud & profiles
- 2" Halo Lit logo bulb yellow & letters halo lit white
- Pin mounted with spacers for halo effect
- Painted to match PMS-116c & PMS-295c
- Wire mesh with retainer, dimensional address numbers
- Pin mounted thru mesh face
- LED lighting to shine up the monument from the top of the shroud
- LED rope lighting inside of angle frame around, 1/4" dimensional address letters, fastened to mesh backer
- White aluminum behind address mesh

Colors

- Pantone 295c
- Pantone 116c
- White

Revisions

- Revision 1: Scale full address (21700 Doral Rd). LED Lighting around yellow top rectangle to shine at address, White painted alum. to hide address from the back of the sign.
- Revision 2: Address back to 21700 (original placement good). Would like to see 6" height on the address #'s instead of code 8". (Claims they don't notice the difference when going for permit. :) Add yellow halo light for the yellow bulb only.

Scroll Down
For Next Page



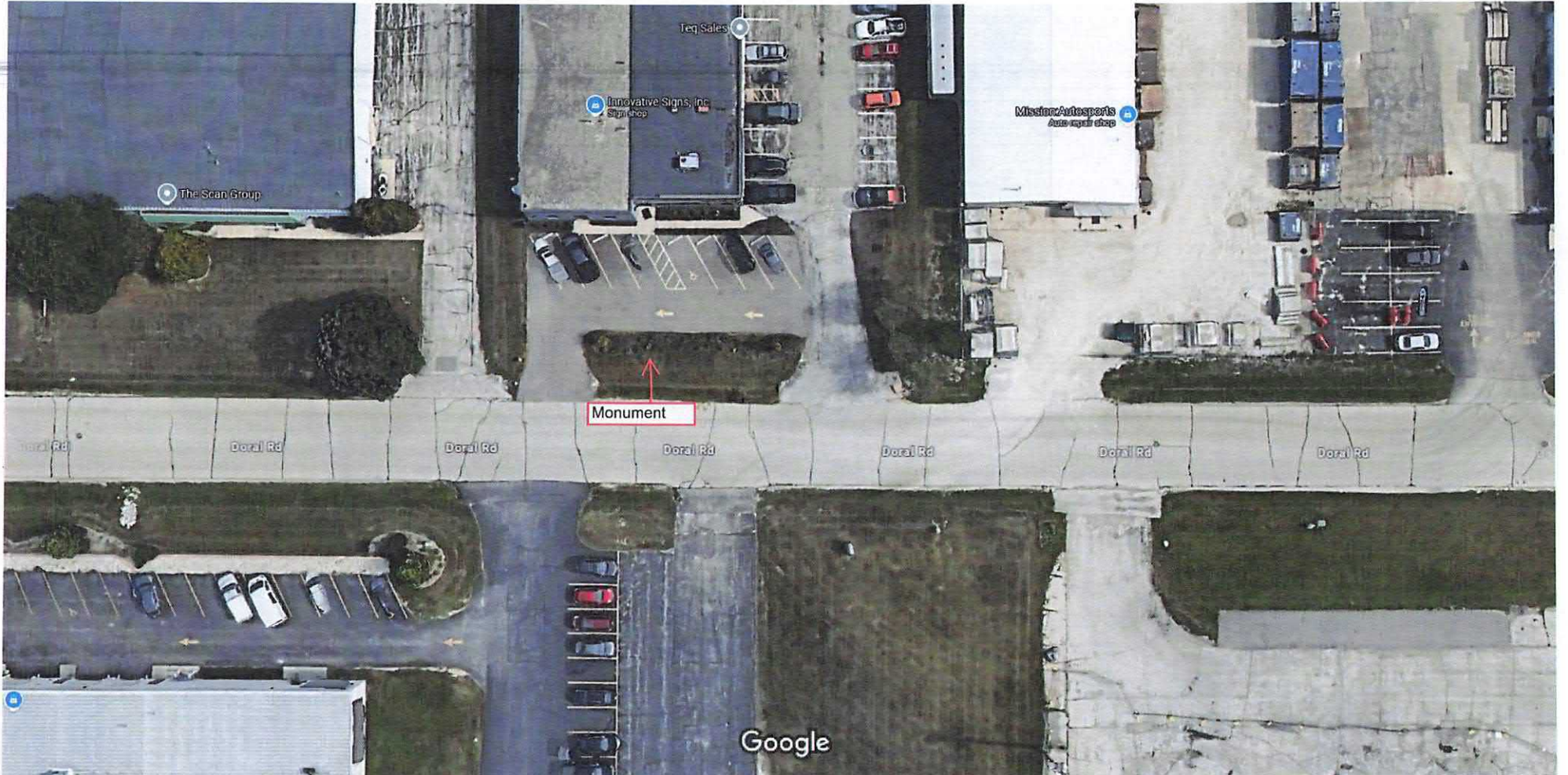

SITE PLAN



"We Project Your Image"

PH: (262) 554-6066
TOLL FREE: (800) 554-8110

Client: SILGAN CONTAINERS	Date: 07-30-24	REVISION		Illumination: <input type="checkbox"/> NO <input type="checkbox"/> YES TYPE _____ Electrical Requirements: <input type="checkbox"/> 120 <input type="checkbox"/> 277	<input type="checkbox"/> SINGLE SIDED <input type="checkbox"/> DOUBLE SIDED Quantity: _____	Paint Colors (AkzoNobel): <input type="checkbox"/> _____ <input type="checkbox"/> _____ <input type="checkbox"/> _____ <input type="checkbox"/> _____ <input type="checkbox"/> _____ <input type="checkbox"/> _____	Vinyl Film Colors (3M Scotchcal): <input type="checkbox"/> _____ <input type="checkbox"/> _____ <input type="checkbox"/> _____ <input type="checkbox"/> _____ <input type="checkbox"/> _____ <input type="checkbox"/> _____	Client Signature: _____ Signature _____ Date _____
	Drawing #: 1(1)	Sheet: 1 of 1 Scale: NA Designer: JJ	△ 1-30-25 △ △ △ △ △ △ △	Sign Specifications: NOTED ABOVE		NOTICE: Michael's Signs, Inc. does NOT provide primary electrical to sign location - RESPONSIBILITY OF OTHERS The ideas and designs contained in this original and unpublished drawing are the sole property of Michael's Signs, Inc. and MAY NOT BE USED OR REPRODUCED in whole or in part without written permission.		

NOTE: DUE TO THE PHYSICAL LIMITATIONS OF THE PAPER AND INK INVOLVED IN THIS PRINTING PROCESS, THIS CUSTOM ARTWORK IS NOT INTENDED TO PROVIDE AN EXACT MATCH TO THE ACTUAL FINISHED PAINTED PRODUCT.

MONUMENT OVERLAY

A



PROPOSED NIGHT VIEW



EXISTING (SIGN A)



PROPOSED (SIGN A)



SILGAN / MONUMENT SIGN OVERLAYS

PANEL OVERLAYS FOR DOUBLE SIDED ILLUMINATED MONUMENT SIGN
 .125 ALUMINUM PANELS WITH ROUTED COPY WITH BACKUP WHITE ACRYLIC
 PANEL TO BE MAP PAINTED TO MATCH PMS 431 AND ® TO BE 3M WHITE 7725-10 VINYL
 EXISTING SIGN FACE TO BE CUT OUT AND NEW PANEL TO BE STUD MOUNTED FLUSH
 OPTION EXISTING MONUMENT PAINTED TO MATCH PMS 431 C



"We Project Your Image"

PH: (262) 554-6066
 TOLL FREE: (800) 554-8110

Client: SILGAN CONTAINERS Address: 21027 CROSSROADS CR City, State: WAUKESHA, WI 53186 Sales Rep: STEPHEN PROCHASKA	Date: 1-30-25	REVISION		Illumination: <input type="checkbox"/> NO <input checked="" type="checkbox"/> YES TYPE _____	<input type="checkbox"/> SINGLE SIDED <input checked="" type="checkbox"/> DOUBLE SIDED	Paint Colors (AkzoNobel): <input checked="" type="checkbox"/> PAINTED TO MATCH PMS 431	Vinyl Film Colors (3M Scotchcal): <input checked="" type="checkbox"/> 7725-10 WHITE VINYL	Client Signature: _____ Signature _____ Date _____
	Drawing #: 1(0)	<input type="checkbox"/> <input type="checkbox"/>	<input type="checkbox"/> <input type="checkbox"/>	Electrical Requirements: <input type="checkbox"/> 120 <input type="checkbox"/> 277	Quantity: 1	<input type="checkbox"/> <input type="checkbox"/> <input type="checkbox"/> <input type="checkbox"/> <input type="checkbox"/> <input type="checkbox"/>	<input type="checkbox"/> <input type="checkbox"/> <input type="checkbox"/> <input type="checkbox"/> <input type="checkbox"/> <input type="checkbox"/>	NOTICE: Michael's Signs, Inc. does NOT provide primary electrical to sign location - RESPONSIBILITY OF OTHERS
	Sheet: 1 of 1	<input type="checkbox"/> <input type="checkbox"/>	<input type="checkbox"/> <input type="checkbox"/>	Sign Specifications: NOTED ABOVE		<input type="checkbox"/> <input type="checkbox"/> <input type="checkbox"/> <input type="checkbox"/> <input type="checkbox"/> <input type="checkbox"/>	<input type="checkbox"/> <input type="checkbox"/> <input type="checkbox"/> <input type="checkbox"/> <input type="checkbox"/> <input type="checkbox"/>	The ideas and designs contained in this original and unpublished drawing are the sole property of Michael's Signs, Inc. and MAY NOT BE USED OR REPRODUCED in whole or in part without written permission.
	Scale: 1" = 1'	<input type="checkbox"/> <input type="checkbox"/>	<input type="checkbox"/> <input type="checkbox"/>					
	Designer: JJ	<input type="checkbox"/> <input type="checkbox"/>	<input type="checkbox"/> <input type="checkbox"/>					

NOTE: DUE TO THE PHYSICAL LIMITATIONS OF THE PAPER AND INK INVOLVED IN THIS PRINTING PROCESS, THIS CUSTOM ARTWORK IS NOT INTENDED TO PROVIDE AN EXACT MATCH TO THE ACTUAL FINISHED PAINTED PRODUCT.

BUILDING SIGN

B

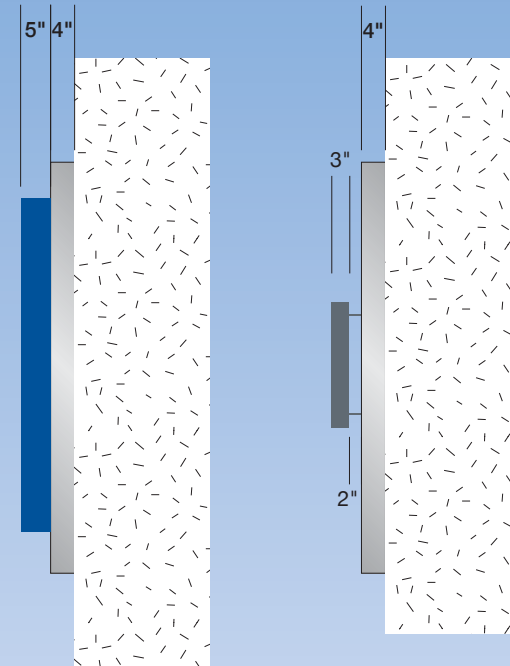
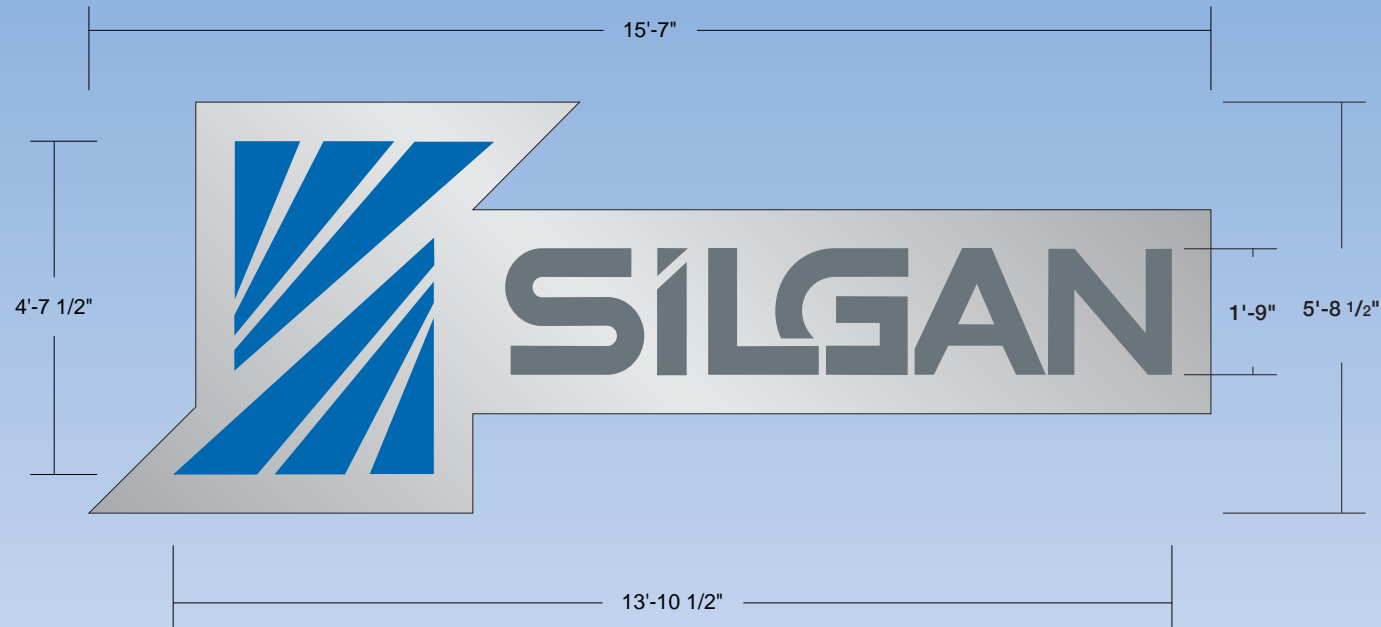

SIDE VIEW - NTS STANDARD CHANNEL **SIDE VIEW - NTS REVERSE LIT**

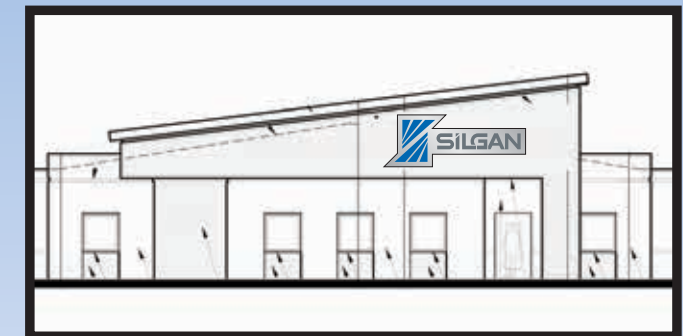

EXISTING LOCATION (OCONOMOWOC)

SILGAN CONTAINERS / BUILDING SIGN

REMOVE FROM EXISTING LOCATION & INSTALL AT NEW

ORIGINAL SPECS FROM EXISTING SIGN

- ONE (1) SINGLE SIDED, INTERNALLY ILLUMINATED BUILDING SIGN
- CUSTOM FABRICATED ALUMINUM PAN SIGN W/ MAP PAINTED FINISH (MAP BRUSHED ALUM.)
- STANDARD CHANNEL LETTERS (LOGO): .063 ALUMINUM BACKS
- .040 ALUMINUM RETURNS (PAINT TO MATCH FACE COLOR), 1" TRIM CAP (TO MATCH FACE COLOR)
- WHITE PLEXI FACES W/ 3M VINYL GRAPHICS, LETTERS INTERNALLY ILLUMINATED W/ WHITE LEDS
- REVERSE LIT (SILGAN): .125 ALUMINUM FACES (PMS 431), .063 ALUMINUM RETURNS, CLEAR LEXAN BACKS
- WHITE LED ILLUMINATION, MOUNT TO CABINET W/ 1/4" STUDS STOOD OFF PAN 2"
- FABRICATED ALUMINUM PAN SIGN PAINTED MAP BRUSHED ALUM.
- PAN CLEAT MOUNTED FLUSH TO FASCIA



NEW LOCATION (NORTH ELEVATION)
SCALE: NTS

PROPORTIONS ARE ESTIMATED

Client: SILGAN CONTAINERS	Date: 1-30-25	REVISION		Illumination: <input type="checkbox"/> NO <input checked="" type="checkbox"/> YES TYPE LED <input checked="" type="checkbox"/> SINGLE SIDED <input type="checkbox"/> DOUBLE SIDED	Paint Colors (AkzoNobel): <input type="checkbox"/> <input type="checkbox"/> <input type="checkbox"/> <input type="checkbox"/> <input type="checkbox"/> <input type="checkbox"/>	Vinyl Film Colors (3M Scotchcal): <input type="checkbox"/> <input type="checkbox"/> <input type="checkbox"/> <input type="checkbox"/> <input type="checkbox"/> <input type="checkbox"/>	Client Signature: _____ Signature _____ Date _____
	Drawing #: 1(3)	1 <input type="checkbox"/> 01-30-25 <input type="checkbox"/>	2 <input type="checkbox"/> 02-12-25 <input type="checkbox"/>	Electrical Requirements: <input type="checkbox"/> 120 <input type="checkbox"/> 277	Quantity: 1	NOTICE: Michael's Signs, Inc. does NOT provide primary electrical to sign location - RESPONSIBILITY OF OTHERS The ideas and designs contained in this original and unpublished drawing are the sole property of Michael's Signs, Inc. and MAY NOT BE USED OR REPRODUCED in whole or in part without written permission.	
Address: 5701 FRONTIER ROAD	Sheet: 1 of 1	3 <input type="checkbox"/> 3-5-25 <input type="checkbox"/>	Sign Specifications: NOTED ABOVE				
City, State: OCONOMOWOC, WI 53066	Scale: 3/8"=1'	Designer: HC					
Sales Rep: STEPHEN PROCHASKA							

NOTE: DUE TO THE PHYSICAL LIMITATIONS OF THE PAPER AND INK INVOLVED IN THIS PRINTING PROCESS, THIS CUSTOM ARTWORK IS NOT INTENDED TO PROVIDE AN EXACT MATCH TO THE ACTUAL FINISHED PAINTED PRODUCT.

BUILDING SIGN

C

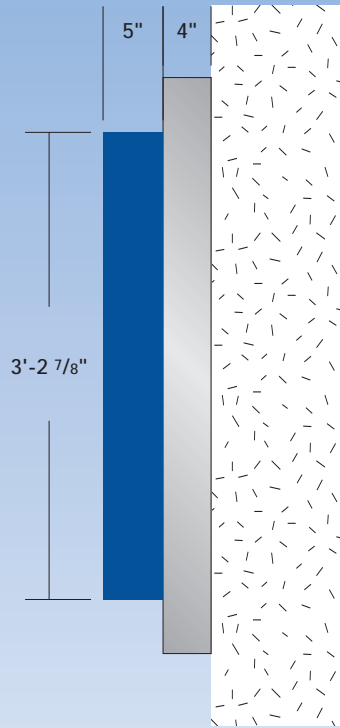
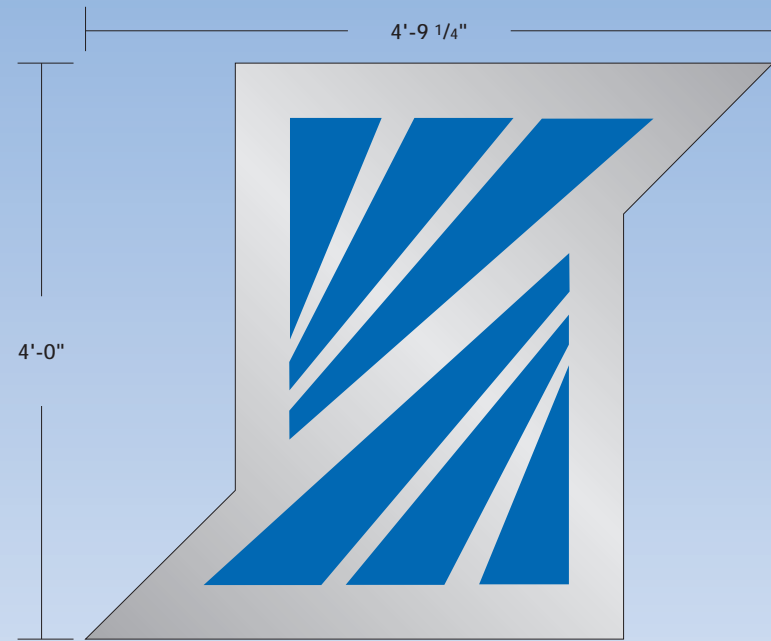

**SIDE VIEW
STANDARD CHANNEL**



**EAST ELEVATION
NTS**



NIGHT RENDERING

SILGAN CONTAINERS / BUILDING SIGN

ONE (1) SINGLE SIDED, ILLUMINATED BUILDING SIGN
 CUSTOM FABRICATED ALUMINUM PAN SIGN W/ MAP PAINTED FINISH (MAP BRUSHED ALUM.)
 STANDARD CHANNEL LETTERS (LOGO): .063 ALUMINUM BACKS
 .040 ALUMINUM RETURNS (PMS 287C), 1" TRIM CAP (PMS 287C)
 WHITE PLEXI FACES W/ 3M VINYL GRAPHICS, SIGN INTERNALLY ILLUMINATED W/ WHITE LEDS



"We Project Your Image"

PH: (262) 554-6066
 TOLL FREE: (800) 554-8110

Client: SILGAN CONTAINERS Address: 21027 CROSSROADS CR City, State: WAUKESHA, WI 53186 Sales Rep: STEPHEN PROCHASKA	Date: 1-30-25 Drawing #: 2 (2)	REVISION 1 01-30-25 2 02-12-25	Illumination: <input type="checkbox"/> NO <input checked="" type="checkbox"/> YES TYPE LED Electrical Requirements: <input type="checkbox"/> 120 <input type="checkbox"/> 277	<input checked="" type="checkbox"/> SINGLE SIDED <input type="checkbox"/> DOUBLE SIDED Quantity: 1	Paint Colors (AkzoNobel): <input checked="" type="checkbox"/> MAP BRUSHED ALUMINUM	Vinyl Film Colors (3M Scotchcal): <input checked="" type="checkbox"/> 3M SULTAN BLUE TRANS.	Client Signature: Signature _____ Date _____
	Sheet: 1 of 1 Scale: 3/4"=1' Designer: HC	Sign Specifications: NOTED ABOVE	NOTICE: Michael's Signs, Inc. does NOT provide primary electrical to sign location - RESPONSIBILITY OF OTHERS The ideas and designs contained in this original and unpublished drawing are the sole property of Michael's Signs, Inc. and MAY NOT BE USED OR REPRODUCED in whole or in part without written permission.				

NOTE: DUE TO THE PHYSICAL LIMITATIONS OF THE PAPER AND INK INVOLVED IN THIS PRINTING PROCESS, THIS CUSTOM ARTWORK IS NOT INTENDED TO PROVIDE AN EXACT MATCH TO THE ACTUAL FINISHED PAINTED PRODUCT.

OVERLAY PANELS 1



SILGAN / POST & PANEL OVERLAYS

3MM DIBOND PANELS WITH DIGITAL PRINTED VINYL OVERLAY
 INSTALLED OVER EXISTING SIGN FACE WITH DOUBLE SIDED TAPE
 OPTION EXISTING POST & PANEL PAINTED TO MATCH PMS 431 C



PROPOSED (SIGN 1)
 W/ EXISTING POST & PANEL PAINTED PMS 431



Client: SILGAN CONTAINERS Address: 21027 CROSSROADS CR City, State: WAUKESHA, WI 53186 Sales Rep: STEPHEN PROCHASKA	Date: 07-30-24	REVISION		Illumination: <input checked="" type="checkbox"/> NO <input type="checkbox"/> YES TYPE _____	<input type="checkbox"/> SINGLE SIDED <input type="checkbox"/> DOUBLE SIDED	Paint Colors (AkzoNobel): *OPTION* MATCH PMS 431	Vinyl Film Colors (3M Scotchcal): DIGITAL PRINT	Client Signature: _____ Signature _____ Date _____	
	Drawing #: 1(2)	Sheet: 1 of 1	Scale: 1" = 1'	Electrical Requirements: <input type="checkbox"/> 120 <input type="checkbox"/> 277	Quantity: NOTED	Sign Specifications: NOTED ABOVE	NOTICE: Michael's Signs, Inc. does NOT provide primary electrical to sign location - RESPONSIBILITY OF OTHERS	The ideas and designs contained in this original and unpublished drawing are the sole property of Michael's Signs, Inc. and MAY NOT BE USED OR REPRODUCED in whole or in part without written permission.	
	Date: 09-16-24	Date: 1-30-25	Designer: JJ/HC						

NOTE: DUE TO THE PHYSICAL LIMITATIONS OF THE PAPER AND INK INVOLVED IN THIS PRINTING PROCESS, THIS CUSTOM ARTWORK IS NOT INTENDED TO PROVIDE AN EXACT MATCH TO THE ACTUAL FINISHED PAINTED PRODUCT.

OVERLAY PANELS 2



SILGAN / POST & PANEL OVERLAYS

3MM DIBOND PANELS WITH DIGITAL PRINTED VINYL OVERLAY
 INSTALLED OVER EXISTING SIGN FACE WITH DOUBLE SIDED TAPE
 OPTION EXISTING POST & PANEL PAINTED TO MATCH PMS 431 C



EXISTING (SIGN 8)
 W/ EXISTING POST & PANEL PAINTED PMS 431



"We Project Your Image"

PH: (262) 554-6066
 TOLL FREE: (800) 554-8110

Client: SILGAN CONTAINERS	Date: 07-30-24	REVISION		Illumination: <input checked="" type="checkbox"/> NO <input type="checkbox"/> YES TYPE _____ Electrical Requirements: <input type="checkbox"/> 120 <input type="checkbox"/> 277	<input type="checkbox"/> SINGLE SIDED <input type="checkbox"/> DOUBLE SIDED Quantity: NOTED	Paint Colors (AkzoNobel): <input checked="" type="checkbox"/> *OPTION* MATCH PMS 431	Vinyl Film Colors (3M Scotchcal): <input checked="" type="checkbox"/> DIGITAL PRINT	Client Signature: _____ Signature _____ Date _____
	Drawing #: 1(2)	△ 09-16-24	△	Sign Specifications: NOTED ABOVE				NOTICE: Michael's Signs, Inc. does NOT provide primary electrical to sign location - RESPONSIBILITY OF OTHERS The ideas and designs contained in this original and unpublished drawing are the sole property of Michael's Signs, Inc. and MAY NOT BE USED OR REPRODUCED in whole or in part without written permission.
Address: 21027 CROSSROADS CR	Sheet: 1 of 1	△ 1-30-25	△					
City, State: WAUKESHA, WI 53186	Scale: 1" = 1'	△	△					
Sales Rep: STEPHEN PROCHASKA	Designer: JJ/HC	△	△					

NOTE: DUE TO THE PHYSICAL LIMITATIONS OF THE PAPER AND INK INVOLVED IN THIS PRINTING PROCESS, THIS CUSTOM ARTWORK IS NOT INTENDED TO PROVIDE AN EXACT MATCH TO THE ACTUAL FINISHED PAINTED PRODUCT.

PARCEL 1
635 M. NO.
OWNER: KTFM MILWAUKEE LLC
EAST 305.00'

110' EASEMENT STRIP TO AT&T
PER DOC. NO. 3541483



2 STORY BLOCK BUILDING #21027

AREA
8,871
BUILDING HEIGHT=27.9

Calculation Summary						
Label	CalcType	Units	Avg	Max	Min	Max/Min
DRIVE LANE AND LOADING DOCK	ILLUMINANCE	Fc	0.95	7.7	0.0	N.A.
MAIN ENTRY	ILLUMINANCE	Fc	0.31	1.2	0.0	N.A.
PROPERTY LINE	ILLUMINANCE	Fc	0.25	16.4	0.0	N.A.
SITE	ILLUMINANCE	Fc	5.01	37.6	0.1	50.10

Luminaire Schedule									
Symbol	Qty	Label	Manufacturer	Description	Arrangement	Lum. Lumens	Lum. Watts	LLF	
□	8	FL		FDCX_180_G1_4K	Single	17730	135.1	0.400	
□	6	OA		ALF LS230 T4 G1 4K WALL MOUNT	Single	23068	140.4	0.350	
□	4	SP1		ALF LS230 T4 G1 4K	Single	23068	140.4	0.900	
□	12	SP2		ALF LS230 T5 G1 4K	Back-Back	23566	140.21	0.900	
□	1	SP3		ALF LS230 T5 G1 4K	2 @ 90 degrees	23566	140.21	0.900	
□	2	SP4		ALF LS230 T5 G1 4K	4 @ 90 Degrees	23566	140.21	0.900	
+	6	ST		SL650L	Single	708	12.4952	0.300	

- Standard Reflectance of 80/50/20 unless noted otherwise
- Not a Construction Document, for Design purposes only
- Standard indoor calc points @ 30' A.F.F. unless noted otherwise
- Standard outdoor calc points @ Grade unless noted otherwise
- Egress calc points @ 0' A.F.F.
- Mlazgar Associates assumes no responsibility for installed light levels due to field conditions, etc.

Comments	Date	#
Revisions		

RLMA Project #: 165504
Drawn By: BS
Date: 2/27/2025
Scale: 1" = 25'

LYONS ELECTRIC

Since 1979

powered by design

ELECTRICAL LIGHTING SUBMITTAL

To: MSI General
Attn: Ken Krahe

Project: Silgan
21027 crossroads circle
Brookfield, WI

Submittal Number: (1)

Division: Electrical
Specification Section: 26 51 00
Description: Product Data- Site Lighting

LYONS ELECTRIC APPROVAL STAMP

APPROVED
 APPROVED AS NOTED
 REVISE & RESUBMIT

Please review and send this submittal back as product will not be ordered until submittal is APPROVED.

Date: July 05, 2024

By: *Kevin Konkel*
Kevin Konkel
Design/Estimating Department Manager
Designer of Engineering Systems
Certified Master Electrician
TC Lyons Electric

75 Enterprise Rd.
262-646-6828

Delafield, WI 53018
262-646-6829

www.lyons-electric.com



Project: SILGAN
 Catalog #: ALF LS230 T4 G1 4K
 Fixture Type: SP1
 Notes: CONTRACTOR-TC LYONS ELECTRIC
 BY HEIN ELECTRIC SUPPLY COMPAN

ALF G1

LED Area Light Selectable **CONTRACTOR XP**

Due to continuous product improvements, specification and/or equipment updates may change without notice.



(Images are shown for illustration purposes only)



ALF Medium Selectable Area Light
 (Pictured with Adjustable Pole Mount)

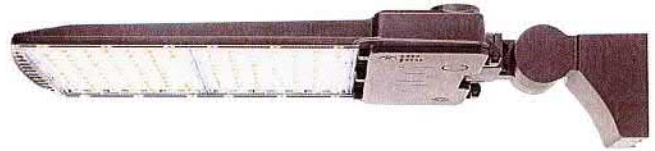

ALF Large Selectable Area Light
 (Pictured with Adjustable Pole Mount)

SPECIFICATIONS

Housing One-piece die cast aluminum housing sealed against moisture and environmental contaminants' features. PIN receptacle	Mounting Square/Round Pole and Slipfitter Mounting options.	Lumen Output Medium Area Light Field selectable: 10,000 / 23,000 Lm Large Area Light Field selectable: LS450 model: 20,000 / 45,000 Lm LS600 model: 47,000 / 60,500 Lm	Electrical Standard 120-277 VAC HVU Option 277-480 VAC 0-10 V dimming driver	Warranty 5-year limited warranty Comprehensive warranty terms can be located on www.slgus.com	Certifications UL Listed, IP65 rated, FCC compliant, Design Light's Consortium* (DLC15.1) Premium qualified product.
Ambient Temperature Suitable for use in -40°C to 45°C (-40°F to 113°F). LS600 Model: 40°C to 40°C (-40°F to 104°F).	Efficacy Up to 162 lumens per watt.	Full Cutoff Full cutoff luminaire when installed at a level 90° angle to the ground.	Optics Available in IES Type II, III, IV, and V distributions. Polycarbonate lens. Can conform to dark sky requirements.	Lifespan L70 > 72,000 hours @ 25°C	
CCT and CRI Field selectable: 3000K, 4000K, and 5000K / 70 CRI					

ORDERING GUIDE

Example: ALF LS220 T3 G1 FSK PSC ASR

Fixture	Selectable Lumen Output	Distribution	Generation	Voltage	Selectable CCT	Photocell	Included Mount	Finish <i>SPECIFY FINISH</i>	Controls (Optional)	Accessories
<ul style="list-style-type: none"> ALF LED Area Light-Flexible 	<ul style="list-style-type: none"> LS230 10,000 Lm / 60 W 15,500 Lm / 85 W 20,000 Lm / 110 W 23,000 Lm / 140 W LS450 20,000 Lm / 120 W 28,500 Lm / 180 W 38,500 Lm / 240 W 45,000 Lm / 300 W LS600^Q 47,000 Lm / 300 W 51,000 Lm / 320 W 56,000 Lm / 360 W 60,500 Lm / 400 W 	<ul style="list-style-type: none"> T2 Type II T3 Type III T4 Type IV T5 Type V 	<ul style="list-style-type: none"> G1 First Generation 	<ul style="list-style-type: none"> BLANK 120-277 V HVU* 347-480 V 	<ul style="list-style-type: none"> FSK 3000K 4000K 5000K 	PSC Ships with Photocell and Shorting Cap. BLANK Leave this blank when ordering HVU models - these do not include photocell and shorting cap.	<ul style="list-style-type: none"> ASR Adjustable Square and Round Pole Mount (ships in same box) SFD Slipfitter Mount (ships in same box) 	<ul style="list-style-type: none"> BLANK Dark Bronze B Black W White SG Silver Gray C** Custom Color 	<ul style="list-style-type: none"> PC-2 Twist-lock Photocell (480V) OSLg sync Networked Controls MSB-DCE-06-W-BT5.0 Bluetooth Plug-in Sensor/Controller - Photocell+PIR (MSB-20-L7-W NDI included) MSB-DCE-06-W Bluetooth Sensor, Daylight Harvest+PIR L3 Medium Bay lens, L7 High Bay lens FCB-DCE-02-W Bluetooth Plug-in Controller Node Standalone Controls MS-DCE-09-W Standalone Motion Sensor RM06 Remote controller for standalone motion sensor 	<ul style="list-style-type: none"> ALF-M-EGS External glare shield for ALF LS230 (available in Dark Bronze, black, silver, and white) ALF-L-EGS External glare shield for ALF LS450 / LS600 (available in Dark Bronze, black, silver, and white) ALF-M-HGS Housing side glare shield for ALF LS230 (available in Dark Bronze, black, silver, and white) ALF-L-HGS Housing side glare shield for ALF LS450 / LS600 (available in Dark Bronze, black, silver, and white) ALF-M-BLS Back light control for ALF LS230 ALF-L-BLS Back light control for ALF LS450 / LS600
					<ul style="list-style-type: none"> FSK^Q 4000K 5000K 		Additional mounts ship separately.			
							<ul style="list-style-type: none"> ALC-SPAR Square and Round Pole Mount ALC-WMB Wall Mount ALC-T Trunnion Mount 			

* HVU option does not ship with PIN receptacle, Photocell, Shorting cap, or ASR mount.

**For a custom color, please call to place your order.

^Q ALF LS600 model is 4000K/5000K switch selectable.

ALF G1



CATALOGUE

DARK BRONZE 120-277V

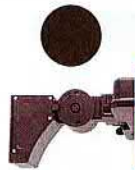

Adjustable Pole mount

Catalog Number	Dist.	Description	Lumens	Watts	CCT	Voltage	Mount
ALF LS230 T3 G1 FSK PSC ASR	T3	Area Light - 4 Level Wattage Adjustable, Gen1, With 3 Pin Photocell & Shorting Cap	Selectable 10,000 - 23,000 Lm	Selectable 60 - 140W	Selectable 3000K - 5000K	120-277V	Included Adjustable Pole Mount
ALF LS230 T4 G1 FSK PSC ASR	T4	Area Light - 4 Level Wattage Adjustable, Gen1, With 3 Pin Photocell & Shorting Cap	Selectable 10,000 - 23,000 Lm	Selectable 60 - 140W	Selectable 3000K - 5000K	120-277V	Included Adjustable Pole Mount
ALF LS230 T5 G1 FSK PSC ASR	T5	Area Light - 4 Level Wattage Adjustable, Gen1, With 3 Pin Photocell & Shorting Cap	Selectable 10,000 - 23,000 Lm	Selectable 60 - 140W	Selectable 3000K - 5000K	120-277V	Included Adjustable Pole Mount
ALF LS450 T3 G1 FSK PSC ASR	T3	Area Light - 4 Level Wattage Adjustable, Gen1, With 3 Pin Photocell & Shorting Cap	Selectable 20,000 - 45,000 Lm	Selectable 120 - 300W	Selectable 3000K - 5000K	120-277V	Included Adjustable Pole Mount
ALF LS450 T4 G1 FSK PSC ASR	T4	Area Light - 4 Level Wattage Adjustable, Gen1, With 3 Pin Photocell & Shorting Cap	Selectable 20,000 - 45,000 Lm	Selectable 120 - 300W	Selectable 3000K - 5000K	120-277V	Included Adjustable Pole Mount
ALF LS450 T5 G1 FSK PSC ASR	T5	Area Light - 4 Level Wattage Adjustable, Gen1, With 3 Pin Photocell & Shorting Cap	Selectable 20,000 - 45,000 Lm	Selectable 120 - 300W	Selectable 3000K - 5000K	120-277V	Included Adjustable Pole Mount
ALF LS600 T3 G1 FSK PSC ASR	T3	Area Light - 4 Level Wattage Adjustable, Gen1, With 3 Pin Photocell & Shorting Cap	Selectable 47,000 - 60,500 Lm	Selectable 300 - 400W	Selectable 4000K - 5000K	120-277V	Included Adjustable Pole Mount
ALF LS600 T4 G1 FSK PSC ASR	T4	Area Light - 4 Level Wattage Adjustable, Gen1, With 3 Pin Photocell & Shorting Cap	Selectable 47,000 - 60,500 Lm	Selectable 300 - 400W	Selectable 4000K - 5000K	120-277V	Included Adjustable Pole Mount
ALF LS600 T5 G1 FSK PSC ASR	T5	Area Light - 4 Level Wattage Adjustable, Gen1, With 3 Pin Photocell & Shorting Cap	Selectable 47,000 - 60,500 Lm	Selectable 300 - 400W	Selectable 4000K - 5000K	120-277V	Included Adjustable Pole Mount



Slipfitter mount

Catalog Number	Dist.	Description	Lumens	Watts	CCT	Voltage	Mount
ALF LS230 T3 G1 FSK PSC SFD	T3	Area Light - 4 Level Wattage Adjustable, Gen1, With 3 Pin Photocell & Shorting Cap	Selectable 10,000 - 23,000 Lm	Selectable 60 - 140W	Selectable 3000K - 5000K	120V-277V	Included Slipfitter Mount
ALF LS450 T3 G1 FSK PSC SFD	T3	Area Light - 4 Level Wattage Adjustable, Gen1, With 3 Pin Photocell & Shorting Cap	Selectable 20,000 - 45,000 Lm	Selectable 120 - 300W	Selectable 3000K - 5000K	120-277V	Included Slipfitter Mount
ALF LS230 T4 G1 FSK PSC SFD	T4	Area Light - 4 Level Wattage Adjustable, T4, Gen1, With 3 Pin Photocell & Shorting Cap	Selectable 10,000 - 23,000 Lm	Selectable 60 - 140W	Selectable 3000K - 5000K	120-277V	Included Slipfitter Mount
ALF LS230 T5 G1 FSK PSC SFD	T5	Area Light - 4 Level Wattage Adjustable, T5, Gen1, With 3 Pin Photocell & Shorting Cap	Selectable 10,000 - 23,000 Lm	Selectable 60 - 140W	Selectable 3000K - 5000K	120-277V	Included Slipfitter Mount
ALF LS450 T4 G1 FSK PSC SFD	T4	Area Light - 4 Level Wattage Adjustable, T4, Gen1, With 3 Pin Photocell & Shorting Cap	Selectable 20,000 - 45,000 Lm	Selectable 120 - 300W	Selectable 3000K - 5000K	120-277V	Included Slipfitter Mount
ALF LS450 T5 G1 FSK PSC SFD	T5	Area Light - 4 Level Wattage Adjustable, Gen1, With 3 Pin Photocell & Shorting Cap	Selectable 20,000 - 45,000 Lm	Selectable 120 - 300W	Selectable 3000K - 5000K	120-277V	Included Slipfitter Mount
ALF LS600 T3 G1 FSK PSC SFD	T3	Area Light - 4 Level Wattage Adjustable, Gen1, With 3 Pin Photocell & Shorting Cap	Selectable 47,000 - 60,500 Lm	Selectable 300 - 400W	Selectable 4000K - 5000K	120-277V	Included Slipfitter Mount
ALF LS600 T4 G1 FSK PSC SFD	T4	Area Light - 4 Level Wattage Adjustable, Gen1, With 3 Pin Photocell & Shorting Cap	Selectable 47,000 - 60,500 Lm	Selectable 300 - 400W	Selectable 4000K - 5000K	120-277V	Included Slipfitter Mount
ALF LS600 T5 G1 FSK PSC SFD	T5	Area Light - 4 Level Wattage Adjustable, Gen1, With 3 Pin Photocell & Shorting Cap	Selectable 47,000 - 60,500 Lm	Selectable 300 - 400W	Selectable 4000K - 5000K	120-277V	Included Slipfitter Mount

DARK BRONZE HVU 277-480V

Catalog Number	Dist.	Description	Lumens	Watts	CCT	Voltage	Mount
ALF LS230 T3 G1 HVU FSK	T3	Area Light - 4 Level Wattage Adjustable, Gen1, High Voltage	Selectable 10,000 - 23,000 Lm	Selectable 60 - 140W	Selectable 3000K - 5000K	277 - 480V	NOT INCLUDED
ALF LS450 T3 G1 HVU FSK	T3	Area Light - 4 Level Wattage Adjustable, Gen1, High Voltage	Selectable 20,000 - 45,000 Lm	Selectable 120 - 300W	Selectable 3000K - 5000K	277 - 480V	NOT INCLUDED
ALF LS600 T3 G1 HVU FSK	T3	Area Light - 4 Level Wattage Adjustable, Gen1, High Voltage	Selectable 47,000 - 60,500 Lm	Selectable 300 - 400W	Selectable 4000K - 5000K	277 - 480V	NOT INCLUDED

ALF G1



WHITE 120-277V



Adjustable Pole mount



Slipfitter mount

Catalog Number	Dist.	Description	Lumens	Watts	CCT	Voltage	Mount
ALF LS230 T3 G1FSK PSC ASR W	T3	Area Light - 4 Level Wattage Adjustable, Gen1, With 3 Pin Photocell & Shorting Cap, White	Selectable 10,000 - 23,000 Lm	Selectable 60 - 140W	Selectable 3000K - 5000K	120-277V	Included Adjustable Pole Mount
ALF LS450 T3 G1FSK PSC ASR W	T3	Area Light - 4 Level Wattage Adjustable, Gen1, With 3 Pin Photocell & Shorting Cap, White	Selectable 20,000 - 45,000 Lm	Selectable 120 - 300W	Selectable 3000K - 5000K	120-277V	Included Adjustable Pole Mount
ALF LS600 T3 G1FSK PSC ASR W	T3	Area Light - 4 Level Wattage Adjustable, Gen1, With 3 Pin Photocell & Shorting Cap, White	Selectable 47,000 - 60,500 Lm	Selectable 300 - 400W	Selectable 4000K - 5000K	120-277V	Included Adjustable Pole Mount
ALF LS230 T3 G1FSK PSC SFD W	T3	Area Light - 4 Level Wattage Adjustable, Gen1, With 3 Pin Photocell & Shorting Cap, White	Selectable 10,000 - 23,000 Lm	Selectable 60 - 140W	Selectable 3000K - 5000K	120-277V	Included Slipfitter Mount
ALF LS450 T3 G1FSK PSC SFD W	T3	Area Light - 4 Level Wattage Adjustable, Gen1, With 3 Pin Photocell & Shorting Cap, White	Selectable 20,000 - 45,000 Lm	Selectable 120 - 300W	Selectable 3000K - 5000K	120-277V	Included Slipfitter Mount



BLACK 120-277V



Adjustable Pole mount

Catalog Number	Dist.	Description	Lumens	Watts	CCT	Voltage	Mount
ALF LS230 T3 G1FSK PSC ASR B	T3	Area Light - 4 Level Wattage Adjustable, Gen1, With 3 Pin Photocell & Shorting Cap, Black	Selectable 10,000 - 23,000 Lm	Selectable 60 - 140W	Selectable 3000K - 5000K	120-277V	Included Adjustable Pole Mount
ALF LS450 T3 G1FSK PSC ASR B	T3	Area Light - 4 Level Wattage Adjustable, Gen1, With 3 Pin Photocell & Shorting Cap, Black	Selectable 20,000 - 45,000 Lm	Selectable 120 - 300W	Selectable 3000K - 5000K	120-277V	Included Adjustable Pole Mount
ALF LS800 T3 G1FSK PSC ASR B	T3	Area Light - 4 Level Wattage Adjustable, Gen1, With 3 Pin Photocell & Shorting Cap, Black	Selectable 47,000 - 60,500 Lm	Selectable 300 - 400W	Selectable 4000K - 5000K	120-277V	Included Adjustable Pole Mount



SILVER GREY 120-277V



Adjustable Pole mount

Catalog Number	Dist.	Description	Lumens	Watts	CCT	Voltage	Mount
ALF LS230 T3 G1FSK PSC ASR SG	T3	Area Light - 4 Level Wattage Adjustable, Gen1, With 3 Pin Photocell & Shorting Cap, Silver Grey	Selectable 10,000 - 23,000 Lm	Selectable 60 - 140W	Selectable 3000K - 5000K	120-277V	Included Adjustable Pole Mount
ALF LS450 T3 G1FSK PSC ASR SG	T3	Area Light - 4 Level Wattage Adjustable, Gen1, With 3 Pin Photocell & Shorting Cap, Silver Grey	Selectable 20,000 - 45,000 Lm	Selectable 120 - 300W	Selectable 3000K - 5000K	120-277V	Included Adjustable Pole Mount
ALF LS600 T3 G1FSK PSC ASR SG	T3	Area Light - 4 Level Wattage Adjustable, Gen1, With 3 Pin Photocell & Shorting Cap, Silver Grey	Selectable 47,000 - 60,500 Lm	Selectable 300 - 400W	Selectable 4000K - 5000K	120-277V	Included Adjustable Pole Mount

Type II and additional options available upon special request.

ALF DIMENSIONS

ALF LS230 W/ Adjustable Pole Mount

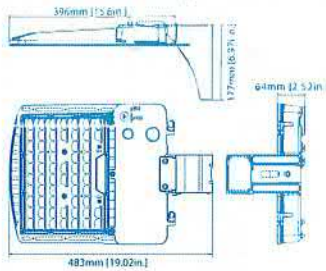

ALF LS450/LS600 W/ Adjustable Pole Mount

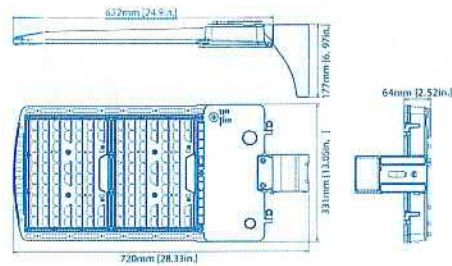

ALF LS230 W/ Adjustable Slipfitter Mount

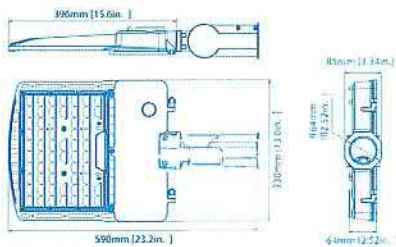

ALF LS450/LS600 W/ Adjustable Slipfitter Mount

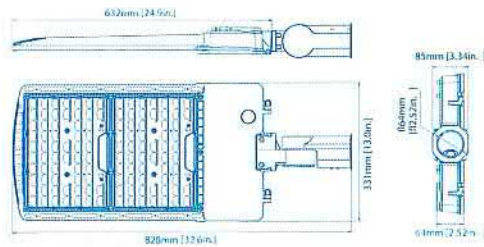

ALF LS230 W/ Wall Mount

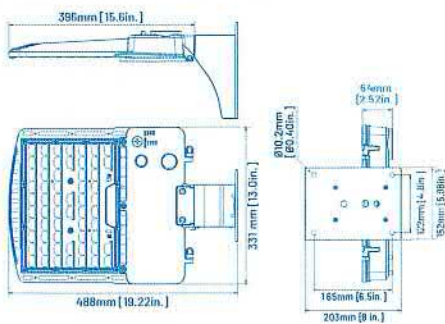

ALF LS450/LS600 W/ Wall Mount

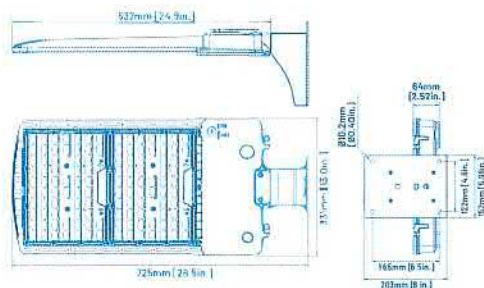

ALF LS230 W/ Trunnion Mount

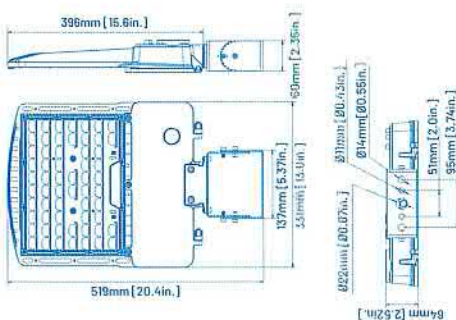

ALF LS450/LS600 W/ Trunnion Mount

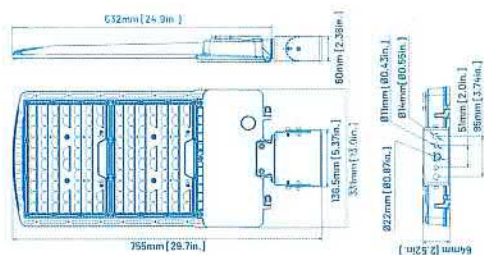

MOUNTING DIMENSIONS

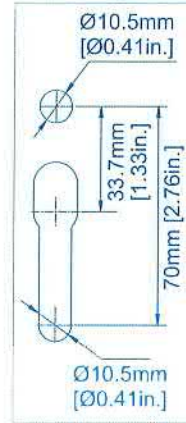
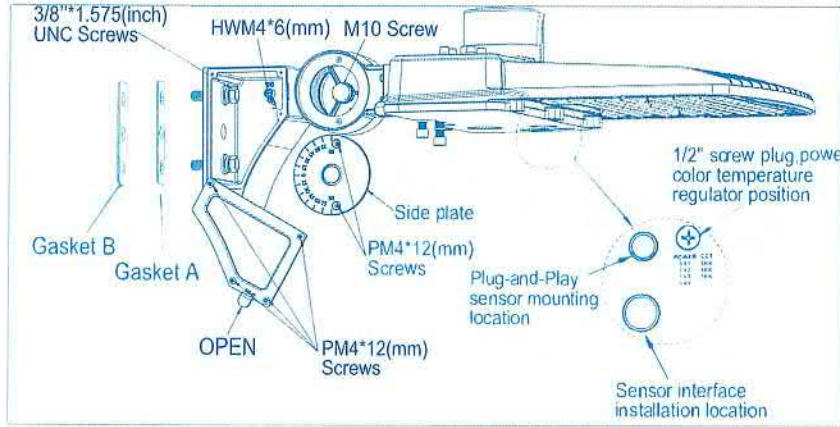

ASR
Adjustable
Square and
Round Pole
Mount



ALC-SPAR



SFD
Slipfitter
Mount



ALC-WMB



ALC-T

PHOTOMETRIC

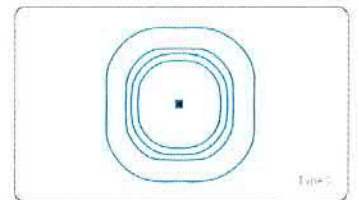
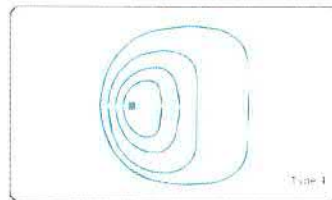
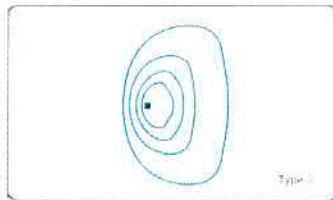
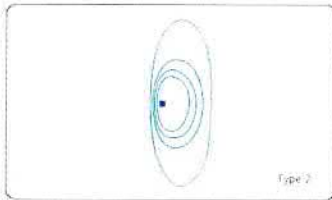

ALF G1



ELECTRICAL LOAD

	Power Setting	Wattage	Current (A)					Current (A)	
			120V	200V	240V	277V		347V	480V
ALF LS230	Low	60 W	0.5	0.29	0.29	0.22	ALF LS230 HVU	0.17	0.13
	Med	85 W	0.71	0.41	0.41	0.31		0.24	0.18
	High	110 W	0.92	0.53	0.53	0.4		0.32	0.23
	Max	140 W	1.17	0.67	0.67	0.51		0.4	0.29
ALF LS450	Low	120 W	1	0.58	0.5	0.43	ALF LS450 HVU	0.35	0.25
	Med	180 W	1.5	0.87	0.75	0.65		0.52	0.38
	High	240 W	2	1.15	1	0.87		0.69	0.5
	Max	300 W	2.5	1.44	1.25	1.08		0.86	0.63
ALF LS600	Low	300 W	2.5	1.4	1.25	1.1	ALF LS600 HVU	0.86	0.63
	Med	320 W	2.7	1.5	1.3	1.2		0.92	0.67
	High	360 W	3	1.7	1.5	1.3		1	0.75
	Max	400 W	3.3	1.9	1.7	1.4		1.2	0.83

EPA OF AREA LIGHT

ITEM								
140W	0.3632	0.6849	0.8861	0.7264	1.0481	1.2078	1.0481	
300W / 400W	0.4758	0.8091	1.059	0.9516	1.2849	1.3923	1.2849	

BUG @5000K

MODEL #	SYSTEM WATTS	VOLTAGE	DIST. TYPE	B	U	G
ALF LS230 T3	140W	120-277V / 277-480V	III	3	0	3
ALF LS450 T3	300W	120-277V / 277-480V	III	4	0	4
ALF LS600 T3	400W	120-277V / 277-480V	III	5	0	5

ALF G1



PERFORMANCE

Series Number	Power Percentage	Wattage	DIST. TYPE	CRI	3000K		4000K		5000K	
					LUMENS	LPW	LUMENS	LPW	LUMENS	LPW
ALF LS230	100%	140 W	III	70	19,200 Lm	143 Lm/W	23,000 Lm	164 Lm/W	21,000 Lm	150 Lm/W
	80%	120 W	III	70	18,000 Lm	150 Lm/W	20,000 Lm	167 Lm/W	18,500 Lm	154 Lm/W
	60%	90 W	III	70	14,000 Lm	156 Lm/W	15,500 Lm	172 Lm/W	14,500 Lm	161 Lm/W
	40%	60 W	III	70	9,700 Lm	162 Lm/W	10,600 Lm	177 Lm/W	10,000 Lm	167 Lm/W
ALF LS450	100%	300 W	III	70	41,000 Lm	137 Lm/W	45,000 Lm	150 Lm/W	42,000 Lm	140 Lm/W
	80%	240 W	III	70	35,000 Lm	146 Lm/W	38,500 Lm	160 Lm/W	36,000 Lm	150 Lm/W
	60%	180 W	III	70	28,000 Lm	156 Lm/W	30,000 Lm	167 Lm/W	28,500 Lm	158 Lm/W
	40%	120 W	III	70	19,200 Lm	160 Lm/W	21,500 Lm	179 Lm/W	20,000 Lm	167 Lm/W
ALF LS600	100%	400 W	III	70	N/A		60,500 Lm	151 Lm/W	60,000 Lm	150 Lm/W
	80%	360 W	III	70		56,000 Lm	156 Lm/W	55,000 Lm	153 Lm/W	
	60%	320 W	III	70		51,000 Lm	159 Lm/W	50,000 Lm	156 Lm/W	
	40%	300 W	III	70		47,000 Lm	162 Lm/W	46,000 Lm	159 Lm/W	

ACCESSORIES



PSC
Twist-lock Photocell (120-277V)
with shading cap
(ship with all 120-277V ALF models)



PC-2
Twist-lock Photocell (480V)



MSB-DCE-06-W
Bluetooth Plug-in Controller/
Sensor



MS-DCE-09-W
Standalone Motion Sensor



FCB-DCE-02-W
Bluetooth Plug-in Node



GLARE SHIELDS

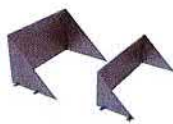

ALF-EGS

External Glare Shields

Catalog Number	Compatible Model	Finish
ALF-M-EGS	ALF LS230	Dark Bronze
ALF-M-EGS-W	ALF LS230	White
ALF-M-EGS-B	ALF LS230	Black
ALF-M-EGS-SG	ALF LS230	Silver Grey

Catalog Number	Compatible Model	Finish
ALFL-EGS	ALF LS450 / LS600	Dark Bronze
ALFL-EGS-W	ALF LS450 / LS600	White
ALFL-EGS-B	ALF LS450 / LS600	Black
ALFL-EGS-SG	ALF LS450 / LS600	Silver Grey

ALF-HGS

Housing Side Glare Shields

Catalog Number	Compatible Model	Finish
ALF-M-HGS	ALF LS230	Dark Bronze
ALF-M-HGS-W	ALF LS230	White
ALF-M-HGS-B	ALF LS230	Black
ALF-M-HGS-SG	ALF LS230	Silver Grey

Catalog Number	Compatible Model	Finish
ALFL-HGS	ALF LS450 / LS600	Dark Bronze
ALFL-HGS-W	ALF LS450 / LS600	White
ALFL-HGS-B	ALF LS450 / LS600	Black
ALFL-HGS-SG	ALF LS450 / LS600	Silver Grey

ALF-BLS

Back light control

Catalog Number	Compatible Model
ALF-M-BLS	ALF LS230
ALF-L-BLS	ALF LS450 / LS600

PROJECTED LUMINAIRE MAINTENANCE

ALF LS230 G1 FSK (AT 140W)

LM-80 Testing Details	
Total number of units tested per case temp:	30
Number of failures:	0
Number of units measured:	30
Test duration (hours):	12,000
Tested drive current (mA):	120
Tested case temperature 1 (T _c , °C):	85
Tested case temperature 2 (T _c , °C):	105

Test Data for 85°C Case Temp	
Time (hours)	Lumen Maintenance (%)
0	100.00%
1,000	100.10%
2,000	99.87%
3,000	99.56%
4,000	99.14%
5,000	98.66%
6,000	98.24%
7,000	97.87%
8,000	97.54%
9,000	97.26%
10,000	96.93%
11,000	96.74%
12,000	96.58%

Test Data for 105°C Case Temp	
Time (hours)	Lumen Maintenance (%)
0	100.00%
1,000	99.68%
2,000	99.35%
3,000	98.90%
4,000	98.37%
5,000	97.81%
6,000	97.36%
7,000	96.94%
8,000	96.48%
9,000	96.01%
10,000	95.65%
11,000	95.10%
12,000	94.66%

Results	
Time (t) at which to estimate Lumen maintenance (hours):	50,000
Lumen maintenance at time (t) (%):	86.47%
Reported L70 (hours):	>72,000

ALF LS450 G1 FSK (AT 300W)

LM-80 Testing Details	
Total number of units tested per case temp:	30
Number of failures:	0
Number of units measured:	30
Test duration (hours):	12,000
Tested drive current (mA):	120
Tested case temperature 1 (T _c , °C):	85
Tested case temperature 2 (T _c , °C):	105

Test Data for 85°C Case Temp	
Time (hours)	Lumen Maintenance (%)
0	100.00%
1,000	100.10%
2,000	99.87%
3,000	99.56%
4,000	99.14%
5,000	98.66%
6,000	98.24%
7,000	97.87%
8,000	97.54%
9,000	97.26%
10,000	96.93%
11,000	96.74%
12,000	96.58%

Test Data for 105°C Case Temp	
Time (hours)	Lumen Maintenance (%)
0	100.00%
1,000	99.68%
2,000	99.35%
3,000	98.90%
4,000	98.37%
5,000	97.81%
6,000	97.36%
7,000	96.94%
8,000	96.48%
9,000	96.01%
10,000	95.65%
11,000	95.10%
12,000	94.66%

Results	
Time (t) at which to estimate Lumen maintenance (hours):	50,000
Lumen maintenance at time (t) (%):	86.47%
Reported L70 (hours):	>72,000

DLC Product ID

MODEL NUMBER	ID NUMBER
ALF LS230 T2 G1 FSK	S-SM1CON
ALF LS230 T3 G1 FSK	S-IC8M3S
ALF LS230 T4 G1 FSK	S-CNQPL6
ALF LS230 T5 G1 FSK	S-7W51J3
ALF LS450 T2 G1 FSK	S-VGYJNP
ALF LS450 T3 G1 FSK	S-S5LOTG
ALF LS450 T4 G1 FSK	S-9ALW8H
ALF LS450 T5 G1 FSK	S-LOG3PV
ALF LS600 T2 G1 FSK	S-4YMH0H
ALF LS600 T3 G1 FSK	S-TG286H
ALF LS600 T4 G1 FSK	S-LD6LP9
ALF LS600 T5 G1 FSK	S-9YDMMJ

NOTE: ID numbers apply regardless of mount, finish color, or power type.



Project: SILGAN
 Catalog #: ALF LS230 T5 G1 4K
 Fixture Type: SP2
 Notes: CONTRACTOR-TC LYONS ELECTRIC
 BY HEIN ELECTRIC SUPPLY COMPANY

ALF G1

LED Area Light Selectable **CONTRACTOR XP**

Due to continuous product improvements, specification and/or equipment updates may change without notice.



(Images are shown for illustration purposes only)



ALF Medium Medium Selectable Area Light
 (Pictured with Adjustable Pole Mount)



ALF Large Large Selectable Area Light
 (Pictured with Adjustable Pole Mount)

SPECIFICATIONS

Housing One piece, die cast aluminum housing sealed against moisture and environmental contaminants features PIN receptacle.	Mounting Square/Round Pole and Slipfitter Mounting options.	Lumen Output Medium Area Light Field selectable: 10,000 - 23,000 Lm Large Area Light Field selectable: LS450 model: 20,000 - 45,000 Lm LS600 model: 47,000 - 60,500 Lm	Electrical Standard 120, 277 VAC HVU Option 277, 480 VAC 0-10 V dimming driver.	Warranty 5-year limited warranty. Comprehensive warranty terms can be located on www.slgus.com	Certifications UL Listed, IP65-rated, FCC compliant, Design Lights Consortium* (DLC) 15.1 Premium-qualified product.
Ambient Temperature Suitable for use in -40° C to 45° C (-40° F to 113° F). LS600 Model: -40° C to 40° C (-40° F to 104° F).	Efficacy Up to 162 lumens per watt.	CCT and CRI Field selectable: 3000K, 4000K, and 5000K - 70 CRI	Full Cutoff Full cutoff luminaire when installed at a level 90° angle to the ground.	Optics Available in IES Type II, II, IV, and V distributions. Polycarbonate lens. Can conform to dark sky requirements.	Lifespan L70 > 72,000 hours @ 25° C

ORDERING GUIDE

Example: ALF LS220 T3 G1 FSK PSC ASR

Fixture	Selectable Lumen Output	Distribution	Generation	Voltage	Selectable CCT	Photocell	Included Mount	Finish	Controls (Optional)	Accessories
ALF LED Area Light-Flexible	LS230 10,000 Lm / 60 W 15,500 Lm / 85 W 20,000 Lm / 110 W 23,000 Lm / 140 W LS450 20,000 Lm / 120 W 28,500 Lm / 180 W 38,500 Lm / 240 W 45,000 Lm / 300 W LS600[Ⓢ] 47,000 Lm / 300 W 51,000 Lm / 320 W 56,000 Lm / 360 W 60,500 Lm / 400 W	T2 Type II T3 Type III T4 Type IV T5 Type V	G1 First Generation	BLANK 120-277 V HVU* 347-480 V	FSK 3000K 4000K 5000K FSK[Ⓢ] 4000K 5000K	PSC Ships with Photocell and Shorting Cap. BLANK Leave this blank when ordering HVU models - these do not include photocell and shorting cap.	ASR Adjustable Square and Round Pole Mount (ships in same box) SFD Slipfitter Mount (ships in same box) <i>Additional mounts ship separately.</i> ALC-SPAR Square and Round Pole Mount ALC-WMB Wall Mount ALC-T Trunnion Mount	BLANK Dark Bronze B Black W White SG Silver Gray C** Custom Color	PC-2 Twist-lock Photocell (480V) OSLQ NVC[®] Networked Controls MSB-DCE-06-W-BT5.0 Bluetooth Plug-in Sensor/Controller - Photocell+PIR (MSB-20-L7-W NDT included) MSB-DCE-06-W Bluetooth Sensor, Daylight Harvest+PIR L3 Medium Bay lens L7 High Bay lens FCB-DCE-02-W Bluetooth Plug-in Controller Node Standalone Controls MS-DCE-09-W Standalone Motion Sensor RM06 Remote controller for standalone motion sensor	ALF-M-EGS External glare shield for ALF LS230 (available in Dark Bronze, black, silver, and white) ALF-L-EGS External glare shield for ALF LS450 / LS600 (available in Dark Bronze, black, silver, and white) ALF-M-HGS Housing side glare shield for ALF LS230 (available in Dark Bronze, black, silver, and white) ALF-L-HGS Housing side glare shield for ALF LS450 / LS600 (available in Dark Bronze, black, silver, and white) ALF-M-BLS Back light control for ALF LS230 ALF-L-BLS Back light control for ALF LS450 / LS600

* HVU option does not ship with PIN receptacle, Photocell, shorting cap, or ASR mount.
 **For a custom color, please call to place your order.
 Ⓢ ALF LS600 model is 4000K/5000K switch selectable.

ALF G1



CATALOGUE

DARK BRONZE 120-277V



Adjustable Pole mount

Catalog Number	Dist.	Description	Lumens	Watts	CCT	Voltage	Mount
ALF LS230 T3 G1 FSK PSC ASR	T3	Area Light - 4 Level Wattage Adjustable, Gen1, With 3 Pin Photocell & Shorting Cap	Selectable 10,000 - 23,000 Lm	Selectable 60 - 140W	Selectable 3000K - 5000K	120-277V	Included Adjustable Pole Mount
ALF LS230 T4 G1 FSK PSC ASR	T4	Area Light - 4 Level Wattage Adjustable, Gen1, With 3 Pin Photocell & Shorting Cap	Selectable 10,000 - 23,000 Lm	Selectable 60 - 140W	Selectable 3000K - 5000K	120-277V	Included Adjustable Pole Mount
ALF LS230 T5 G1 FSK PSC ASR	T5	Area Light - 4 Level Wattage Adjustable, Gen1, With 3 Pin Photocell & Shorting Cap	Selectable 10,000 - 23,000 Lm	Selectable 60 - 140W	Selectable 3000K - 5000K	120-277V	Included Adjustable Pole Mount
ALF LS450 T3 G1 FSK PSC ASR	T3	Area Light - 4 Level Wattage Adjustable, Gen1, With 3 Pin Photocell & Shorting Cap	Selectable 20,000 - 45,000 Lm	Selectable 120 - 300W	Selectable 3000K - 5000K	120-277V	Included Adjustable Pole Mount
ALF LS450 T4 G1 FSK PSC ASR	T4	Area Light - 4 Level Wattage Adjustable, Gen1, With 3 Pin Photocell & Shorting Cap	Selectable 20,000 - 45,000 Lm	Selectable 120 - 300W	Selectable 3000K - 5000K	120-277V	Included Adjustable Pole Mount
ALF LS450 T5 G1 FSK PSC ASR	T5	Area Light - 4 Level Wattage Adjustable, Gen1, With 3 Pin Photocell & Shorting Cap	Selectable 20,000 - 45,000 Lm	Selectable 120 - 300W	Selectable 3000K - 5000K	120-277V	Included Adjustable Pole Mount
ALF LS600 T3 G1 FSK PSC ASR	T3	Area Light - 4 Level Wattage Adjustable, Gen1, With 3 Pin Photocell & Shorting Cap	Selectable 47,000 - 60,500 Lm	Selectable 300 - 400W	Selectable 4000K - 5000K	120-277V	Included Adjustable Pole Mount
ALF LS600 T4 G1 FSK PSC ASR	T4	Area Light - 4 Level Wattage Adjustable, Gen1, With 3 Pin Photocell & Shorting Cap	Selectable 47,000 - 60,500 Lm	Selectable 300 - 400W	Selectable 4000K - 5000K	120-277V	Included Adjustable Pole Mount
ALF LS600 T5 G1 FSK PSC ASR	T5	Area Light - 4 Level Wattage Adjustable, Gen1, With 3 Pin Photocell & Shorting Cap	Selectable 47,000 - 60,500 Lm	Selectable 300 - 400W	Selectable 4000K - 5000K	120-277V	Included Adjustable Pole Mount



Slipfitter mount

Catalog Number	Dist.	Description	Lumens	Watts	CCT	Voltage	Mount
ALF LS230 T3 G1 FSK PSC SFD	T3	Area Light - 4 Level Wattage Adjustable, Gen1, With 3 Pin Photocell & Shorting Cap	Selectable 10,000 - 23,000 Lm	Selectable 60 - 140W	Selectable 3000K - 5000K	120V-277V	Included Slipfitter Mount
ALF LS450 T3 G1 FSK PSC SFD	T3	Area Light - 4 Level Wattage Adjustable, Gen1, With 3 Pin Photocell & Shorting Cap	Selectable 20,000 - 45,000 Lm	Selectable 120 - 300W	Selectable 3000K - 5000K	120-277V	Included Slipfitter Mount
ALF LS230 T4 G1 FSK PSC SFD	T4	Area Light - 4 Level Wattage Adjustable, T4, Gen1, With 3 Pin Photocell & Shorting Cap	Selectable 10,000 - 23,000 Lm	Selectable 60 - 140W	Selectable 3000K - 5000K	120-277V	Included Slipfitter Mount
ALF LS230 T5 G1 FSK PSC SFD	T5	Area Light - 4 Level Wattage Adjustable, T5, Gen1, With 3 Pin Photocell & Shorting Cap	Selectable 10,000 - 23,000 Lm	Selectable 60 - 140W	Selectable 3000K - 5000K	120-277V	Included Slipfitter Mount
ALF LS450 T4 G1 FSK PSC SFD	T4	Area Light - 4 Level Wattage Adjustable, T4, Gen1, With 3 Pin Photocell & Shorting Cap	Selectable 20,000 - 45,000 Lm	Selectable 120 - 300W	Selectable 3000K - 5000K	120-277V	Included Slipfitter Mount
ALF LS450 T5 G1 FSK PSC SFD	T5	Area Light - 4 Level Wattage Adjustable, Gen1, With 3 Pin Photocell & Shorting Cap	Selectable 20,000 - 45,000 Lm	Selectable 120 - 300W	Selectable 3000K - 5000K	120-277V	Included Slipfitter Mount
ALF LS600 T3 G1 FSK PSC SFD	T3	Area Light - 4 Level Wattage Adjustable, Gen1, With 3 Pin Photocell & Shorting Cap	Selectable 47,000 - 60,500 Lm	Selectable 300 - 400W	Selectable 4000K - 5000K	120-277V	Included Slipfitter Mount
ALF LS600 T4 G1 FSK PSC SFD	T4	Area Light - 4 Level Wattage Adjustable, Gen1, With 3 Pin Photocell & Shorting Cap	Selectable 47,000 - 60,500 Lm	Selectable 300 - 400W	Selectable 4000K - 5000K	120-277V	Included Slipfitter Mount
ALF LS600 T5 G1 FSK PSC SFD	T5	Area Light - 4 Level Wattage Adjustable, Gen1, With 3 Pin Photocell & Shorting Cap	Selectable 47,000 - 60,500 Lm	Selectable 300 - 400W	Selectable 4000K - 5000K	120-277V	Included Slipfitter Mount

DARK BRONZE HVU 277-480V

Catalog Number	Dist.	Description	Lumens	Watts	CCT	Voltage	Mount
ALF LS230 T3 G1 HVU FSK	T3	Area Light - 4 Level Wattage Adjustable, Gen1, High Voltage	Selectable 10,000 - 23,000 Lm	Selectable 60 - 140W	Selectable 3000K - 5000K	277 - 480V	NOT INCLUDED
ALF LS450 T3 G1 HVU FSK	T3	Area Light - 4 Level Wattage Adjustable, Gen1, High Voltage	Selectable 20,000 - 45,000 Lm	Selectable 120 - 300W	Selectable 3000K - 5000K	277 - 480V	NOT INCLUDED
ALF LS600 T3 G1 HVU FSK	T3	Area Light - 4 Level Wattage Adjustable, Gen1, High Voltage	Selectable 47,000 - 60,500 Lm	Selectable 300 - 400W	Selectable 4000K - 5000K	277 - 480V	NOT INCLUDED

ALF G1



WHITE 120-277V

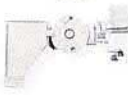

Adjustable Pole mount



Slipfitter mount

Catalog Number	Dist.	Description	Lumens	Watts	CCT	Voltage	Mount
ALF LS230 T3 G1 FSK PSC ASR W	T3	Area Light - 4 Level Wattage Adjustable, Gen1, With 3 Pin Photocell & Shorting Cap, White	Selectable 10,000 - 23,000 Lm	Selectable 60 - 140W	Selectable 3000K - 5000K	120-277V	Included Adjustable Pole Mount
ALF LS450 T3 G1 FSK PSC ASR W	T3	Area Light - 4 Level Wattage Adjustable, Gen1, With 3 Pin Photocell & Shorting Cap, White	Selectable 20,000 - 45,000 Lm	Selectable 120 - 300W	Selectable 3000K - 5000K	120-277V	Included Adjustable Pole Mount
ALF LS600 T3 G1 FSK PSC ASR W	T3	Area Light - 4 Level Wattage Adjustable, Gen1, With 3 Pin Photocell & Shorting Cap, White	Selectable 47,000 - 60,500 Lm	Selectable 300 - 400W	Selectable 4000K - 5000K	120-277V	Included Adjustable Pole Mount
ALF LS230 T3 G1 FSK PSC SFD W	T3	Area Light - 4 Level Wattage Adjustable, Gen1, With 3 Pin Photocell & Shorting Cap, White	Selectable 10,000 - 23,000 Lm	Selectable 60 - 140W	Selectable 3000K - 5000K	120-277V	Included Slipfitter Mount
ALF LS450 T3 G1 FSK PSC SFD W	T3	Area Light - 4 Level Wattage Adjustable, Gen1, With 3 Pin Photocell & Shorting Cap, White	Selectable 20,000 - 45,000 Lm	Selectable 120 - 300W	Selectable 3000K - 5000K	120-277V	Included Slipfitter Mount



BLACK 120-277V



Adjustable Pole mount

Catalog Number	Dist.	Description	Lumens	Watts	CCT	Voltage	Mount
ALF LS230 T3 G1 FSK PSC ASR B	T3	Area Light - 4 Level Wattage Adjustable, Gen1, With 3 Pin Photocell & Shorting Cap, Black	Selectable 10,000 - 23,000 Lm	Selectable 60 - 140W	Selectable 3000K - 5000K	120-277V	Included Adjustable Pole Mount
ALF LS450 T3 G1 FSK PSC ASR B	T3	Area Light - 4 Level Wattage Adjustable, Gen1, With 3 Pin Photocell & Shorting Cap, Black	Selectable 20,000 - 45,000 Lm	Selectable 120 - 300W	Selectable 3000K - 5000K	120-277V	Included Adjustable Pole Mount
ALF LS600 T3 G1 FSK PSC ASR B	T3	Area Light - 4 Level Wattage Adjustable, Gen1, With 3 Pin Photocell & Shorting Cap, Black	Selectable 47,000 - 60,500 Lm	Selectable 300 - 400W	Selectable 4000K - 5000K	120-277V	Included Adjustable Pole Mount



SILVER GREY 120-277V



Adjustable Pole mount

Catalog Number	Dist.	Description	Lumens	Watts	CCT	Voltage	Mount
ALF LS230 T3 G1 FSK PSC ASR SG	T3	Area Light - 4 Level Wattage Adjustable, Gen1, With 3 Pin Photocell & Shorting Cap, Silver Grey	Selectable 10,000 - 23,000 Lm	Selectable 60 - 140W	Selectable 3000K - 5000K	120-277V	Included Adjustable Pole Mount
ALF LS450 T3 G1 FSK PSC ASR SG	T3	Area Light - 4 Level Wattage Adjustable, Gen1, With 3 Pin Photocell & Shorting Cap, Silver Grey	Selectable 20,000 - 45,000 Lm	Selectable 120 - 300W	Selectable 3000K - 5000K	120-277V	Included Adjustable Pole Mount
ALF LS600 T3 G1 FSK PSC ASR SG	T3	Area Light - 4 Level Wattage Adjustable, Gen1, With 3 Pin Photocell & Shorting Cap, Silver Grey	Selectable 47,000 - 60,500 Lm	Selectable 300 - 400W	Selectable 4000K - 5000K	120-277V	Included Adjustable Pole Mount

Type II and additional options available upon special request.

ALF DIMENSIONS

ALF LS230 W/ Adjustable Pole Mount

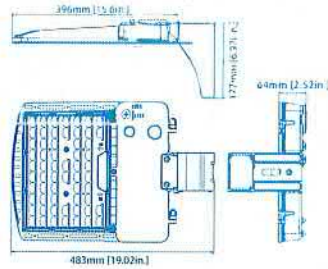

ALF LS450/LS600 W/ Adjustable Pole Mount

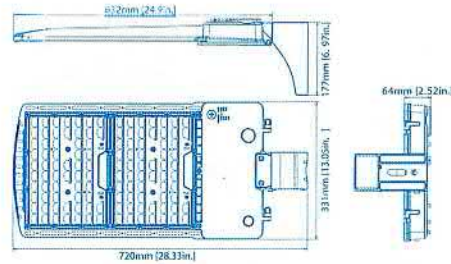

ALF LS230 W/ Adjustable Slipfitter Mount

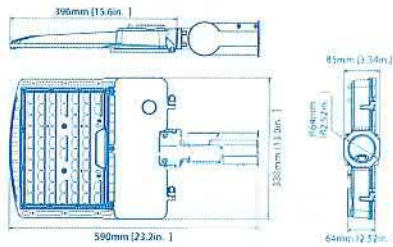

ALF LS450/LS600 W/ Adjustable Slipfitter Mount

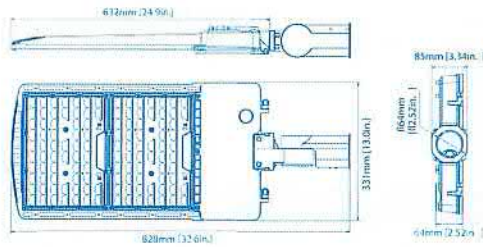

ALF LS230 W/ Wall Mount

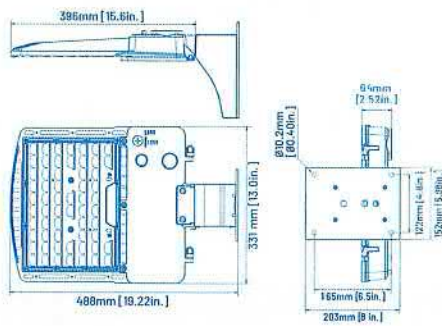

ALF LS450/LS600 W/ Wall Mount

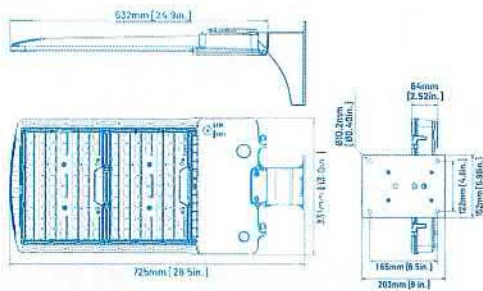

ALF LS230 W/ Trunnion Mount

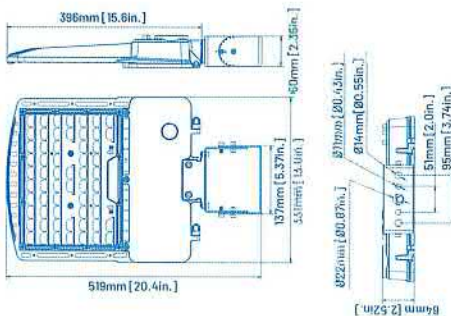

ALF LS450/LS600 W/ Trunnion Mount

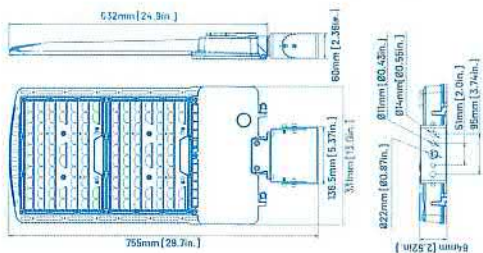

ALF G1



MOUNTING DIMENSIONS

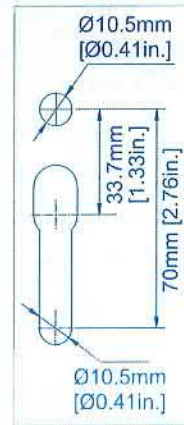
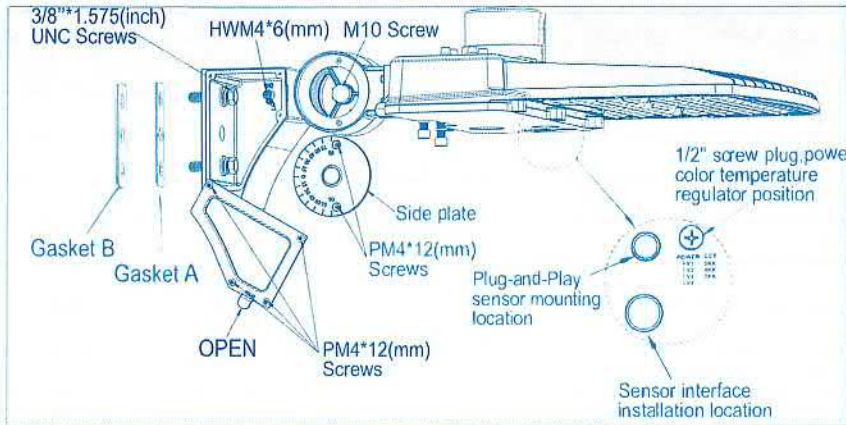

ASR
Adjustable Square and Round Pole Mount



ALC-SPAR

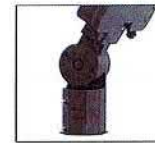

SFD
Slipfitter Mount



ALC-WMB



ALC-T

PHOTOMETRIC

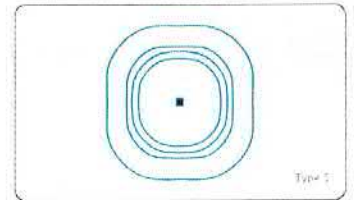
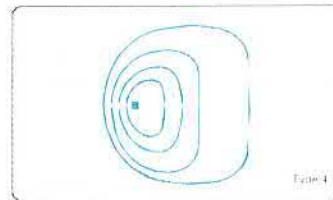
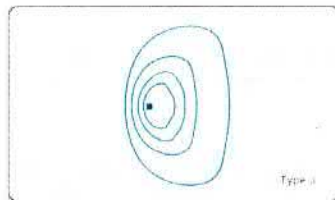
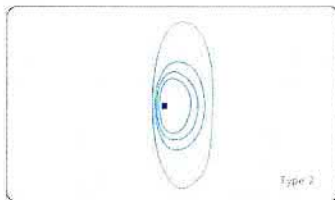

ALF G1



ELECTRICAL LOAD

	Power Setting	Wattage	Current (A)					Current (A)	
			120V	200V	240V	277V		347V	480V
ALF LS230	Low	60 W	0.5	0.29	0.29	0.22	ALF LS230 HVU	0.17	0.13
	Med	85 W	0.71	0.41	0.41	0.31		0.24	0.18
	High	110 W	0.92	0.53	0.53	0.4		0.32	0.23
	Max	140 W	1.17	0.67	0.67	0.51		0.4	0.29
ALF LS450	Low	120 W	1	0.58	0.5	0.43	ALF LS450 HVU	0.35	0.25
	Med	180 W	1.5	0.87	0.75	0.65		0.52	0.38
	High	240 W	2	1.15	1	0.87		0.69	0.5
	Max	300 W	2.5	1.44	1.25	1.08		0.86	0.63
ALF LS600	Low	300 W	2.5	1.4	1.25	1.1	ALF LS600 HVU	0.86	0.63
	Med	320 W	2.7	1.5	1.3	1.2		0.92	0.67
	High	360 W	3	1.7	1.5	1.3		1	0.75
	Max	400 W	3.3	1.9	1.7	1.4		1.2	0.83

EPA OF AREA LIGHT

ITEM								
140W	0.3632	0.6849	0.8861	0.7264	1.0481	1.2078	1.0481	
300W / 400W	0.4758	0.8091	1.059	0.9516	1.2849	1.3923	1.2849	

BUG @5000K

MODEL #	SYSTEM WATTS	VOLTAGE	DIST. TYPE	B	U	G
ALF LS230 T3	140W	120-277V / 277-480V	III	3	0	3
ALF LS450 T3	300W	120-277V / 277-480V	III	4	0	4
ALF LS600 T3	400W	120-277V / 277-480V	III	5	0	5

ALF G1



PERFORMANCE

Series Number	Power Percentage	Wattage	DIST. TYPE	CRI	3000K		4000K		5000K	
					LUMENS	LPW	LUMENS	LPW	LUMENS	LPW
ALF LS230	100%	140 W	III	70	19,200 Lm	143 Lm/W	23,000 Lm	164 Lm/W	21,000 Lm	150 Lm/W
	80%	120 W	III	70	18,000 Lm	150 Lm/W	20,000 Lm	167 Lm/W	18,500 Lm	154 Lm/W
	60%	90 W	III	70	14,000 Lm	156 Lm/W	15,500 Lm	172 Lm/W	14,500 Lm	161 Lm/W
	40%	60 W	III	70	9,700 Lm	162 Lm/W	10,600 Lm	177 Lm/W	10,000 Lm	167 Lm/W
ALF LS450	100%	300 W	III	70	41,000 Lm	137 Lm/W	45,000 Lm	150 Lm/W	42,000 Lm	140 Lm/W
	80%	240 W	III	70	35,000 Lm	146 Lm/W	38,500 Lm	160 Lm/W	36,000 Lm	150 Lm/W
	60%	180 W	III	70	28,000 Lm	156 Lm/W	30,000 Lm	167 Lm/W	28,500 Lm	158 Lm/W
	40%	120 W	III	70	19,200 Lm	160 Lm/W	21,500 Lm	179 Lm/W	20,000 Lm	167 Lm/W
ALF LS600	100%	400 W	III	70	N/A		60,500 Lm	151 Lm/W	60,000 Lm	150 Lm/W
	80%	360 W	III	70		56,000 Lm	156 Lm/W	55,000 Lm	153 Lm/W	
	60%	320 W	III	70		51,000 Lm	159 Lm/W	50,000 Lm	156 Lm/W	
	40%	300 W	III	70		47,000 Lm	162 Lm/W	46,000 Lm	159 Lm/W	

ACCESSORIES



PSC
Twist-lock Photocell (120-277V)
with shorting cap
(ship with all 120-277V ALF models)



PC-2
Twist-lock Photocell (480V)



MSB-DCE-06-W
Bluetooth Plug-in Controller/
Sensor



MS-DCE-09-W
Standalone Motion Sensor



FCB-DCE-02-W
Bluetooth Plug-in Node



GLARE SHIELDS

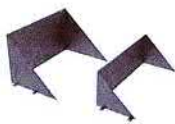

ALF-EGS
External Glare Shields



ALF-HGS
Housing Side
Glare Shields

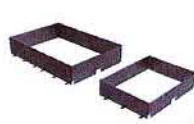

ALF-BLS
Back light control

Catalog Number	Compatible Model	Finish
ALF-M-EGS	ALF LS230	Dark Bronze
ALF-M-EGS-W	ALF LS230	White
ALF-M-EGS-B	ALF LS230	Black
ALF-M-EGS-SG	ALF LS230	Silver Grey

Catalog Number	Compatible Model	Finish
ALFL-EGS	ALF LS450 / LS600	Dark Bronze
ALFL-EGS-W	ALF LS450 / LS600	White
ALFL-EGS-B	ALF LS450 / LS600	Black
ALFL-EGS-SG	ALF LS450 / LS600	Silver Grey

Catalog Number	Compatible Model	Finish
ALF-M-HGS	ALF LS230	Dark Bronze
ALF-M-HGS-W	ALF LS230	White
ALF-M-HGS-B	ALF LS230	Black
ALF-M-HGS-SG	ALF LS230	Silver Grey

Catalog Number	Compatible Model	Finish
ALFL-HGS	ALF LS450 / LS600	Dark Bronze
ALFL-HGS-W	ALF LS450 / LS600	White
ALFL-HGS-B	ALF LS450 / LS600	Black
ALFL-HGS-SG	ALF LS450 / LS600	Silver Grey

Catalog Number	Compatible Model
ALF-M-BLS	ALF LS230
ALF-L-BLS	ALF LS450 / LS600

PROJECTED LUMINAIRE MAINTENANCE

ALF LS230 G1 FSK (AT 140W)

LM-80 Testing Details	
Total number of units tested per case temp:	30
Number of failures:	0
Number of units measured:	30
Test duration (hours):	12,000
Tested drive current (mA):	120
Tested case temperature 1 (T _c , °C):	85
Tested case temperature 2 (T _c , °C):	105

Test Data for 85°C Case Temp	
Time (hours)	Lumen Maintenance (%)
0	100.00%
1,000	100.10%
2,000	99.87%
3,000	99.56%
4,000	99.14%
5,000	98.66%
6,000	98.24%
7,000	97.87%
8,000	97.54%
9,000	97.26%
10,000	96.93%
11,000	96.74%
12,000	96.58%

Test Data for 105°C Case Temp	
Time (hours)	Lumen Maintenance (%)
0	100.00%
1,000	99.68%
2,000	99.35%
3,000	98.90%
4,000	98.37%
5,000	97.81%
6,000	97.36%
7,000	96.94%
8,000	96.48%
9,000	96.01%
10,000	95.65%
11,000	95.10%
12,000	94.66%

Results	
Time (t) at which to estimate Lumen maintenance (hours):	50,000
Lumen maintenance at time (t) (%):	86.47%
Reported L70 (hours):	>72,000

ALF LS450 G1 FSK (AT 300W)

LM-80 Testing Details	
Total number of units tested per case temp:	30
Number of failures:	0
Number of units measured:	30
Test duration (hours):	12,000
Tested drive current (mA):	120
Tested case temperature 1 (T _c , °C):	85
Tested case temperature 2 (T _c , °C):	105

Test Data for 85°C Case Temp	
Time (hours)	Lumen Maintenance (%)
0	100.00%
1,000	100.10%
2,000	99.87%
3,000	99.56%
4,000	99.14%
5,000	98.66%
6,000	98.24%
7,000	97.87%
8,000	97.54%
9,000	97.26%
10,000	96.93%
11,000	96.74%
12,000	96.58%

Test Data for 105°C Case Temp	
Time (hours)	Lumen Maintenance (%)
0	100.00%
1,000	99.68%
2,000	99.35%
3,000	98.90%
4,000	98.37%
5,000	97.81%
6,000	97.36%
7,000	96.94%
8,000	96.48%
9,000	96.01%
10,000	95.65%
11,000	95.10%
12,000	94.66%

Results	
Time (t) at which to estimate Lumen maintenance (hours):	50,000
Lumen maintenance at time (t) (%):	86.47%
Reported L70 (hours):	>72,000

DLC Product ID

MODEL NUMBER	ID NUMBER
ALF LS230 T2 G1 FSK	S-SM1C0N
ALF LS230 T3 G1 FSK	S-IC8M3S
ALF LS230 T4 G1 FSK	S-CN0PL6
ALF LS230 T5 G1 FSK	S-7W51J3
ALF LS450 T2 G1 FSK	S-VGYJNP
ALF LS450 T3 G1 FSK	S-S5LOTG
ALF LS450 T4G1 FSK	S-9ALW8H
ALF LS450 T5 G1 FSK	S-LOG3PV
ALF LS600 T2 G1 FSK	S-4YMH0H
ALF LS600 T3 G1 FSK	S-TG286H
ALF LS600 T4 G1 FSK	S-LD6LP9
ALF LS600 T5 G1 FSK	S-9YDMMJ

NOTE: ID numbers apply regardless of mount, finish color, or power type.



**NAEGELE
AWNING CO.**

2585 S. 33rd St.
Milwaukee WI 53132

office
414.645.2862

mobile/text
414.517.4643

email
**wedoawnings
@sbcglobal.net**

date
February 21, 2025

scale
3/4" = 1'

awning color
**Sunbrella
Captain Navy
4646-0000**



Proposed Awning Above Doorway

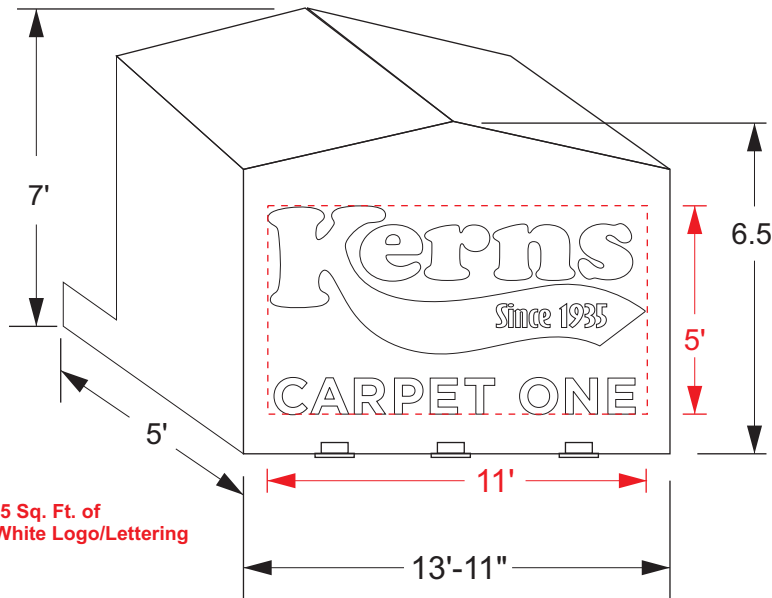

5' x 11' = 55 Sq. Ft. of
Viewable White Logo/Lettering

Front and Side Oblique View

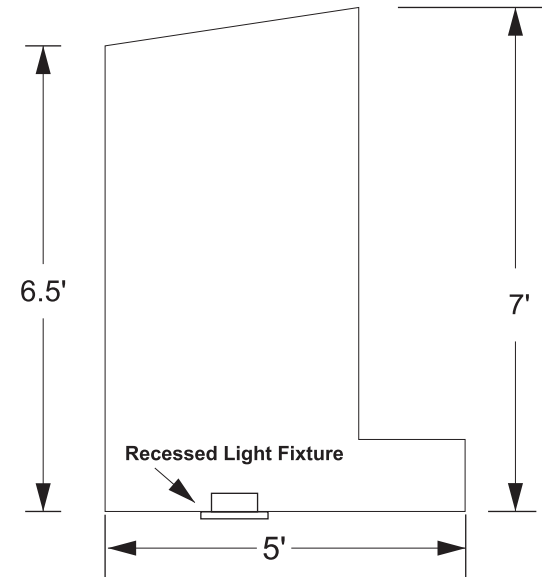

Side View of Awning / Lighting Fixture



**NAEGELE
AWNING CO.**

2585 S. 33rd St.
Milwaukee WI 53132

office
414.645.2862

mobile/text
414.517.4643

email
**wedoawnings
@sbcglobal.net**

date
February 21, 2025

scale
Not to Scale

awning color
**Sunbrella
Captain Navy
4646-0000**



Proposed Awning Above Doorway

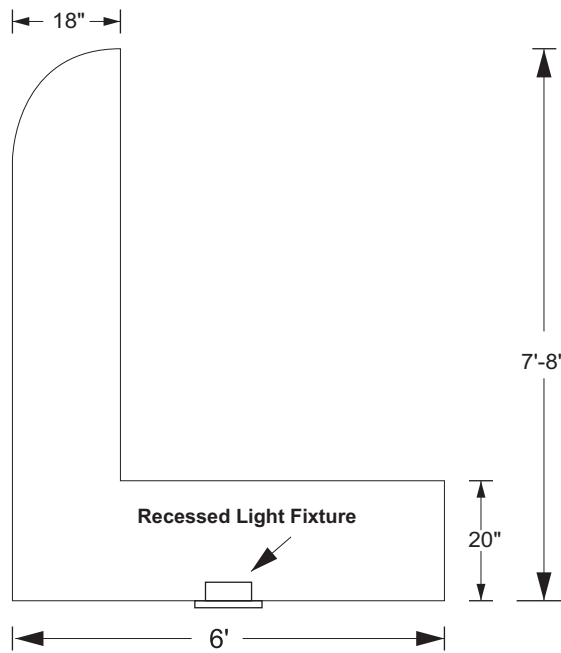

Side View of Awning / Lighting Fixture

Bottom View of Awning w/Lighting Fixtures

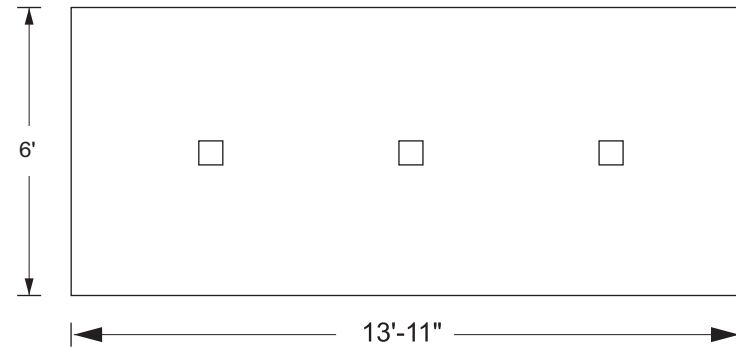

Down Lighting Fixture
3 Fixtures in Total



**NAEGELE
AWNING CO.**

2585 S. 33rd St.
Milwaukee WI 53132

office
414.645.2862

mobile/text
414.517.4643

email
**wedoawnings
@sbcglobal.net**

date
February 21, 2025

scale
Not to Scale

awning color
**Sunbrella
Captain Navy
4646-0000**



Proposed



Setback: 80' from roadway.

Awning Face: 12' w x 6' h x 7'-6" projection from wall.

Height Above Grade: 10' from grade to bottom of awning.

Lettering Copy Area square footage: 11' x 5' = 55 sq.ft.



19655 W Bluemound Rd
Brookfield, WI 53045
(262) 782-4500

February 25, 2025

Town of Brookfield
645 N Janacek Rd
Brookfield, WI 53045

RE: Kerns Carpets Project Summary – 3 Permits for review

Scope of Project:

- Reface the pylon sign, update with LED retrofit and replace light fixture on top
- Reduce the vinyl awning footprint and replace with fabric awning above walkway
- Paint the overhang and soffit to match the awning
- Paint the metal siding and trim a color similar to existing taupe-beige
- Electricians to pull separate permits

Contractors

Signs and Lines by Stretch
Pylon sign face replacement

Naegele Awnings
Awning replacement in smaller footprint

CR Electric
330 W Drexel Oak Creek, WI 53154
Pylon sign LED retrofit

Electrical Concepts Inc.
N8W22520 Johnson Dr. Waukesha, WI 53186
Awning lights and replacement of light atop pylon sign

Alexander Painting and Construction
7443 N Chadwick Rd Milwaukee, WI 53217
Paint the overhang and soffit to match the awning
Paint the metal siding a similar beige (e.g. SW 7038 Tony Taupe)



W240 S3990 Rockwood Circle • Waukesha, WI 53189

262-544-9628 • stretch@slines.net

February 25, 2025

Town of Brookfield

To whom it may concern:

Our customer Kerns Carpet is updating their store exterior.

This includes painting the exterior of the building blue.

Updating the awning color and its look and color.

The existing pylon sign will also be updated. This includes new sign faces and upgrading the interior lighting to LED's. Since the new sign faces will predominately be navy blue. The upgraded lighting will not be fully realized. Most of the sign lighting will be absorbed by the darker background color. The new sign graphic reflects the Kerns logo and business affiliation.

Regards,

A handwritten signature in black ink, appearing to read "Dave", with a horizontal line extending to the right.

Dave

Sign and Lines by Stretch

VERSION: 06

QTY: 1 DOUBLE SIDED BACKLIT PYLON SIGN
- REPLACE EXISTING WITH
NEW FLEX FACE GRAPHICS
MATTE FINISH

BLUE PRINT BREAKDOWN APPROVED
BY CUSTOMER PER SAMPLE SUPPLIED
C-100 M-90 Y-27 K-12



NEW LIGHT FIXTURE
PROVIDED BY CUSTOMER
(NOT INSTALLED BY SIGNS & LINES)



CLIENT: Kerns Carpet
PROJECT: Exterior Signage

Scale: 0" = 0'-0"

DESIGN LAYOUTS ARE COPYRIGHT © 2025



ARTWORK CHARGE: One customer requested revision allowed per drawing/ estimate. There will be an artwork charge for any customer requested revisions.

Designer: Patty Blicharz Date: 02.05.2025

Project: Exterior Signage Install Address: 19655 Bluemound Road, Brookfield, WI 53045

Sales Person: Dave Salkin Project Manager: Dave Salkin

I have checked the DETAILS of this proof and approve the design. Signs & Lines by Stretch is not responsible for typographical errors. My signature authorizes Signs & Lines by Stretch to proceed with production of this order. I understand that I will be charged for product and labor, even if I cancel the order after this date.
Approval: _____ Date: _____

REVISIONS

01:	-----	Revision
02:	-----	Revision
03:	-----	Revision
04:	-----	Revision
05:	-----	Revision
06:	-----	Revision



Area Light Gen 3

150W

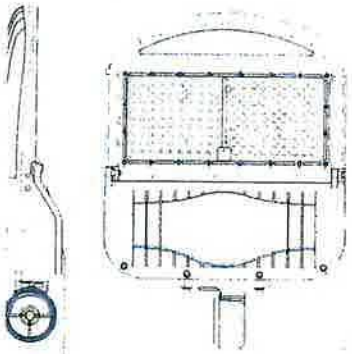

19"

13-1/2"

4-1/4"



**Kerns Carpets LLC
19655 W Bluemound Rd
Brookfield, WI 53045**

Kerns Project Painting: Soffit/fascia

1) Soffit / Fascia: Paint to color-match awning fabric (Sunbrella Captain Navy) using Sherwin Williams



Captain Navy



**Kerns Carpets LLC
19655 W Bluemound Rd
Brookfield, WI 53045**

Kerns Project Painting: Metal siding, trim, garage door

- 2) Rear metal siding, garage door, trim: Paint Tony Taupe (SW 7038)
Replace existing beige address numbers with black numbers, similar sizing.

